

# INDICE DELL' ATTACCO TC - DIN 69871

INDEX OF SK - DIN 69871 SHANK

## RIDUZIONI DA TC A ISO/TC/BT E HSK

TC ADAPTERS TO  
ISO/TC/BT AND HSK



## AUTOSERRANTI INTEGRALI

MONOLITHIC DRILL CHUCKS

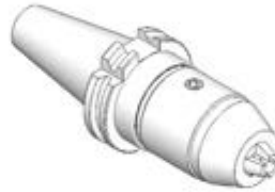

## ATTACCHI PER MANDRINI PORTAPUNTA DIN 238

SHANKS FOR DRILL CHUCKS  
DIN 238 TYPE



## PORTAPINZA ER EXTRACORTI

ER-DIN 6499 COLLET CHUCKS  
WITH INSIDE NUT



## PORTAPINZA ER CON GHIERA MINI

ER-DIN 6499 COLLET CHUCKS  
WITH MINI NUT

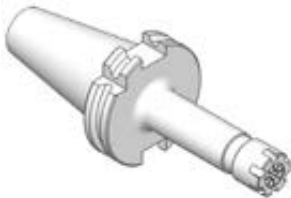

## PORTAPINZA ER CON GHIERA STANDARD

ER-DIN 6499 COLLET CHUCKS  
WITH STANDARD NUT

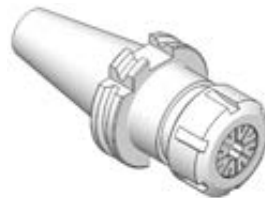

## PORTA MANDRINI CON ATTACCO TRAPEZIO DIN 6327

AUTOMOTIVES SHANK HOLDERS  
ACCORDING TO DIN 6327

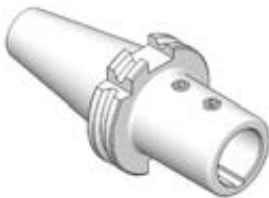

## MANDRINI PER PINZE EOC DIN 6388

DIN 6388 COLLET CHUCKS



## MANDRINI A FORTE SERRAGGIO

HIGH GRIP CHUCKS

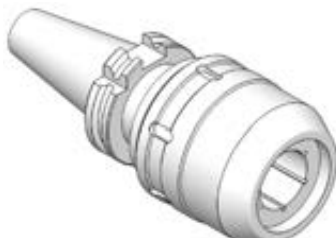

## MANDRINI A SERRAGGIO IDRAULICO

HYDRAULIC CHUCKS



# INDICE DELL' ATTACCO TC - DIN 69871

INDEX OF SK - DIN 69871 SHANK

**BARRE  
A STELO TENERO**  
BLANK BARS

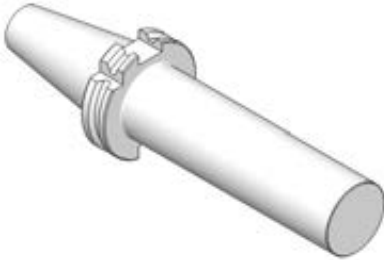

**BARRE  
DI CONTROLLO**  
TEST ARBORS



**PORTAFRESE WELDON  
TIPO EXTRACORTO**  
SHORT TYPE END MILL HOLDERS  
FOR DIN 1835-B SHANKS



**PORTAFRESE WELDON**  
END MILL HOLDERS  
FOR DIN 1835-B SHANKS



**RIDUZIONI  
A CONO MORSE**  
ADAPTERS TO MORSE TAPER



**PORTAFRESE  
FISSI**  
DIN 6357  
FACE MILL HOLDERS



**ATTACCHI PER FRESE  
AD INSERTI**  
FACE MILL HOLDERS FOR  
FACE MILLING CUTTERS

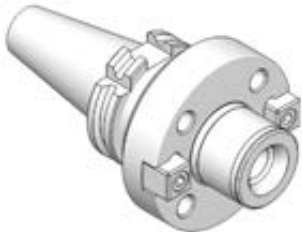

**PORTAFRESE  
COMBINATI**  
DIN 6358 SHELL END  
MILL HOLDERS



**MANDRINI PER FRESE  
CON ATTACCO FILETTATO**  
CHUCKS FOR MILLING CUTTERS  
WITH THREADED SHANK

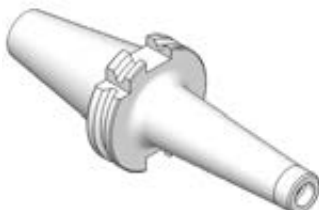

**MASCHIATORI  
A CAMBIO RAPIDO**  
QUICK CHANGE TAP HOLDERS



# CARATTERISTICHE TECNICHE CONI DIN 69871

DIN 69871 TAPER STANDARD FEATURES

**FORMA  
A**

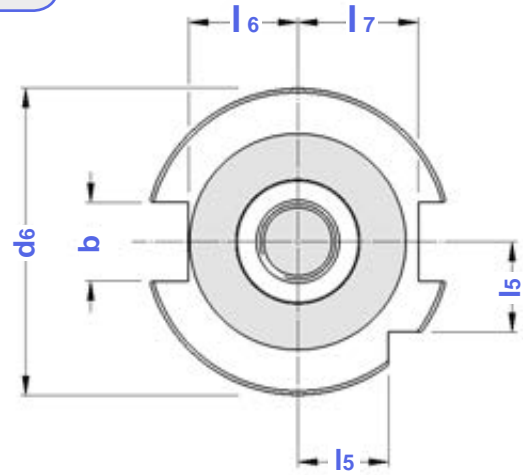
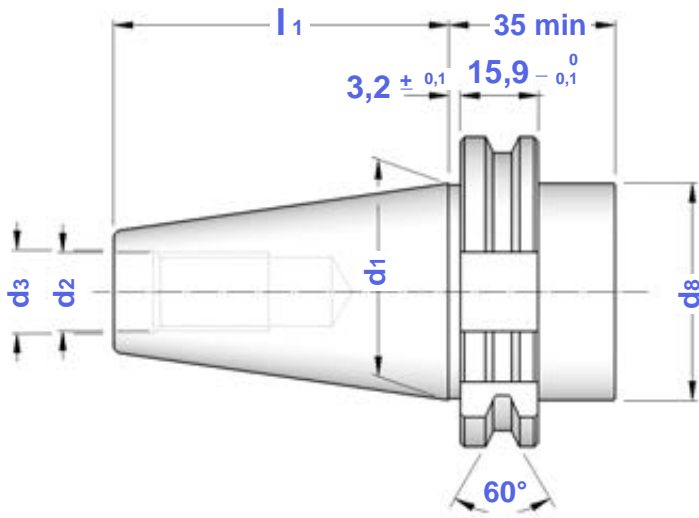

**FORMA  
AD**

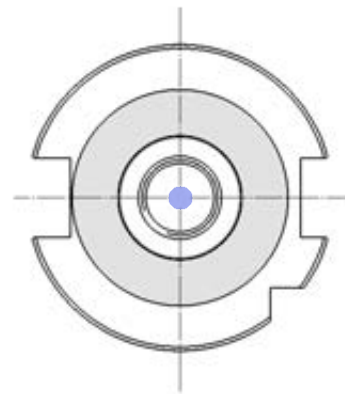
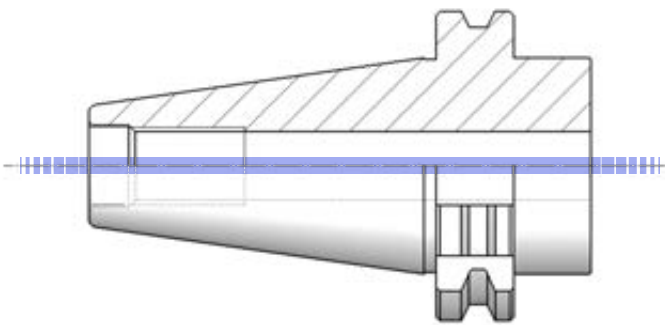

**FORMA  
AD+B**

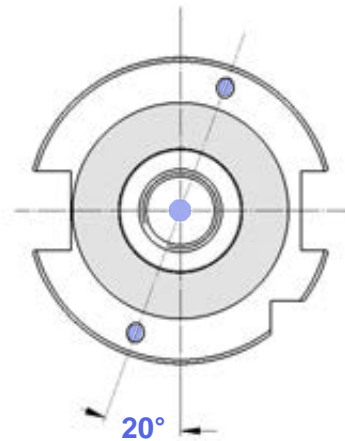
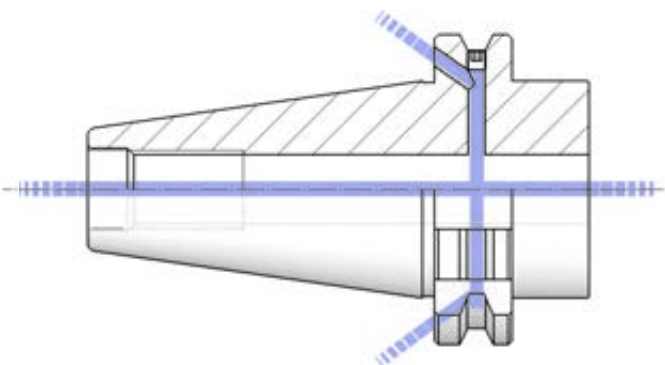

CONO	b	d1	d2	d3	d6	d8	l1	l5	l6	l7	PRECISIONE
TC30 - DIN 69871/A	16,1	31,75	M 12	13	50,00	45	47,80	15,0	16,4	19,0	
TC40 - DIN 69871/A	16,1	44,45	M 16	17	63,55	50	68,40	18,5	22,8	25,0	
TC45 - DIN 69871/A	19,3	57,15	M 20	21	82,55	63	82,70	24,0	29,1	31,3	
TC50 - DIN 69871/A	25,7	69,85	M 24	25	97,50	80	101,75	30,0	35,5	37,7	

**CODOLI DI AGGANCIO**  
PULL STUD BOLTS





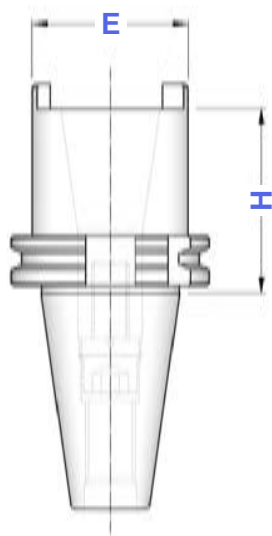

**DIN 69871**

**RIDUZIONI DA TC A ISO/TC/BT**  
TC TO ISO/TC/BT ADAPTERS

**FORMA A**



TIPO	FORMA A						
	Art.	H	E				
TC 40 - ISO 30/TC 30/BT 30	4203	60	50	7423	7410	0177	4570
TC 40 - ISO 40/TC 40/BT 40	8670	100	68	7424	7411	0179	4571
TC 50 - ISO 40/TC 40/BT 40	4257	70	68	7424	7411	0179	4571
TC 50 - ISO 50/TC 50/BT 50	8671	120	100	7426	7417	0254	4780

**DIN 69871**

**RIDUZIONI DA TC AD HSK A+C**  
TC TO HSK A+C ADAPTERS

**FORMA B (AD+B)**

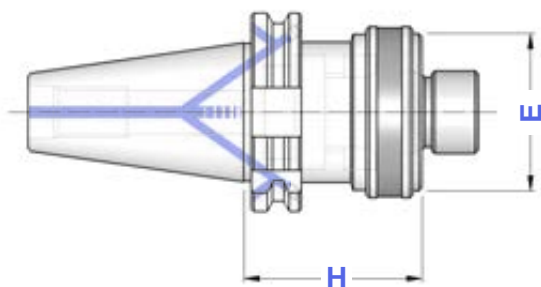

TIPO	FORMA B		
	Art.	H	E
TC 40 - HSK 50 A+C	8688	60	50
TC 40 - HSK 63 A+C	8689	80	63
TC 50 - HSK 63 A+C	8692	60	63



# DIN 69871

## MANDRINI AUTOSERRANTI INTEGRALI ROTAZIONE DESTRA MONOLITHIC DRILL CHUCKS - RIGHT SPIN

### FORMA A

Balanced G 6,3  
12.000 rpm

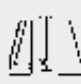
#### FORMA A

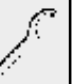
TIPO	Art.	CAPACITA'	E	H			
TC 30 - DC 13	<b>8583</b>	1 ÷ 13	50	110	9016	9021	2370
TC 40 - DC 13	<b>4398</b>	1 ÷ 13	50	100	9016	9021	2370
TC 40 - DC 16	<b>4399</b>	3 ÷ 16	57	115	9017	9023	2371
TC 50 - DC 13	<b>4402</b>	1 ÷ 13	50	100	9016	9021	2370
TC 50 - DC 16	<b>4403</b>	3 ÷ 16	57	105	9017	9023	2371

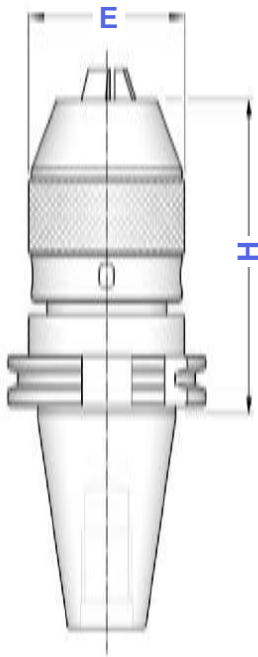

Precisione di rotazione: 0,05 mm  
Runout accuracy: 0,05 mm

# DIN 69871

## MANDRINI AUTOSERRANTI INTEGRALI ROTAZIONE DESTRA E SINISTRA MONOLITHIC DRILL CHUCKS - RIGHT & LEFT SPIN

### FORMA A

### FORMA B (AD+B)

Balanced G 6,3  
12.000 rpm

#### FORMA A    FORMA B

TIPO	Art.	Art.	CAPACITA'	E	H	
TC 30 - DCU 13	<b>8584</b>	—	1 ÷ 13	50	120	2372
TC 40 - DCU 13	<b>8585</b>	<b>8589</b>	1 ÷ 13	50	90	
TC 40 - DCU 16	<b>8586</b>	<b>8590</b>	3 ÷ 16	50	95	2372
TC 50 - DCU 13	<b>8587</b>	<b>8591</b>	1 ÷ 13	50	90	
TC 50 - DCU 16	<b>8588</b>	<b>8592</b>	3 ÷ 16	50	95	

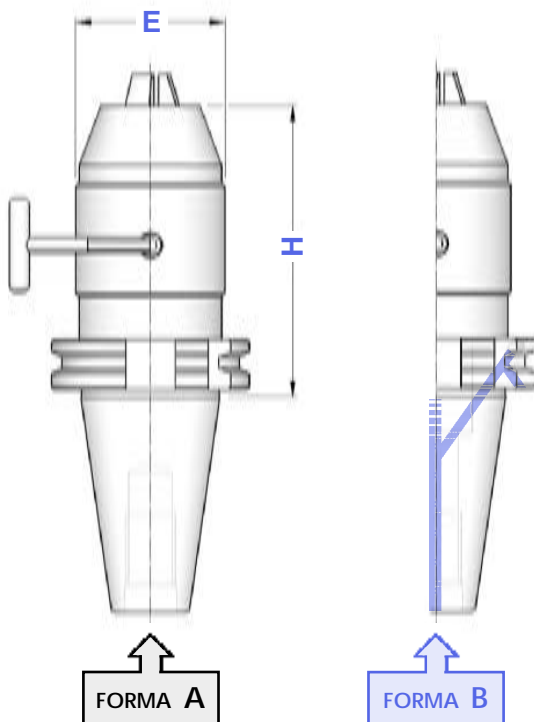

Precisione di rotazione: 0,05 mm  
Runout accuracy: 0,05 mm

# DIN 69871

## ATTACCHI PER MANDRINI PORTAPUNTA DIN 238 SHANKS FOR DRILL CHUCKS DIN 238 TYPE

### FORMA A

Balanced G 6,3  
8.000 rpm

### FORMA A

TIPO	Art.	D	H
TC 30 - B 12	3867	12,065	40
TC 30 - B 16	3868	15,733	40
TC 40 - B 12	3869	12,065	40
TC 40 - B 16	3870	15,733	40
TC 40 - B 18	3871	17,780	40
TC 45 - B 16	3958	15,733	40
TC 50 - B 16	3998	15,733	40
TC 50 - B 18	3999	17,780	40

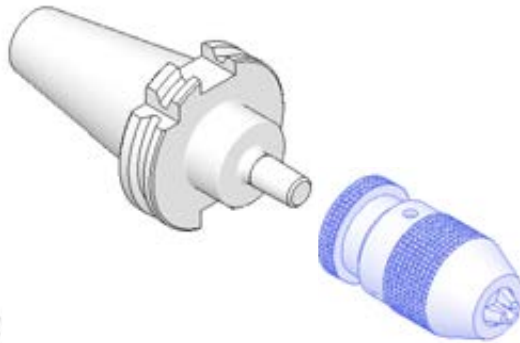
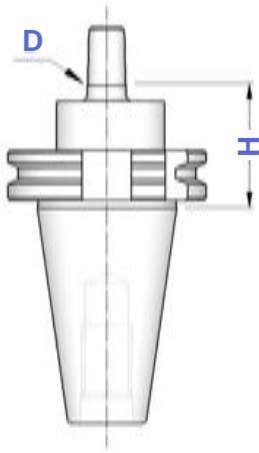





# DIN 69871

## PORTAPINZA ER EXTRACORTI ER - DIN 6499 COLLET CHUCKS WITH INSIDE NUT

### FORMA A (AD)

### FORMA B (AD+B)

Balanced G 6,3  
12.000 rpm

TIPO	FORMA A	FORMA B	H	A	CAPACITA'				
	Art.	Art.							
TC 40 - ER25 GA	8038	8039	21	M 32 x1,5	1 ÷ 16	0073	2870	3172	0996
TC 40 - ER32 GA	3370	—	21	M 40 x1,5	2 ÷ 20	0073	2871	3173	0988
TC 50 - ER32 GA	3371	8040	21	M 40 x1,5	2 ÷ 20	0191	2871	3173	0988

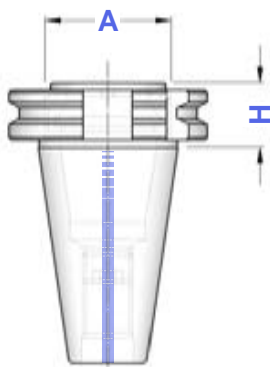

FORMA A

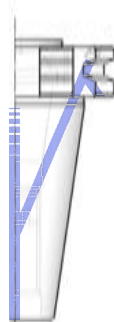



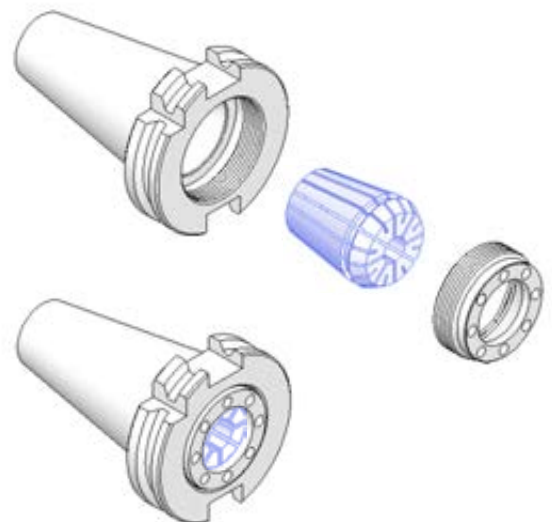

FORMA B



**DIN 69871****PORTAPINZE ER - GHIERA MINI**  
ER - DIN 6499 COLLET CHUCKS WITH MINI NUT**FORMA A (AD)****FORMA B (AD+B)**

Balanced	G 6,3
≤ H100	12.000 rpm
> H100	8.000 rpm

FORMA A	FORMA B
---------	---------

TIPO	Art.	Art.	A	CAPACITA'				
TC 30 - ER 11 GM / H 80	4072	---	16	1 ÷ 7	0181	0432	5718	5573
TC 30 - ER 16 GM / H 80	3001	---	22	1 ÷ 10	0183	1229	5719	0364
TC 30 - ER 16 GM / H120	3432	---						
TC 40 - ER 11 GM / H 70	4073	4720	16	1 ÷ 7	0181	0432	5718	5573
TC 40 - ER 11 GM / H100	4020	4721						
TC 40 - ER 11 GM / H130	4057	4722						
TC 40 - ER 11 GM / H160	3416	4723						
TC 40 - ER 16 GM / H 70	3417	4724	22	1 ÷ 10	0186	1229	5719	0364
TC 40 - ER 16 GM / H100	4074	4748						
TC 40 - ER 16 GM / H130	3433	4749						
TC 40 - ER 16 GM / H160	4014	4021						
TC 40 - ER 16 GM / H200	3418	4026						
TC 40 - ER 20 GM / H 70	3005	4000	28	1 ÷ 13	0188	1230	5720	0787
TC 40 - ER 20 GM / H100	4015	4022						
TC 40 - ER 20 GM / H130	3434	4750						
TC 40 - ER 20 GM / H160	4016	4691						
TC 40 - ER 20 GM / H200	4017	4729						
TC 40 - ER 25 GM / H 70	3007	4001	35	1 ÷ 16	0190	1231	5721	0996
TC 40 - ER 25 GM / H100	4075	4751						
TC 40 - ER 25 GM / H130	3435	4730						
TC 40 - ER 25 GM / H160	3436	4752						
TC 40 - ER 25 GM / H200	3437	4753						
TC 50 - ER 16 GM / H100	3008	4046	22	1 ÷ 10	0186	1229	5719	0364
TC 50 - ER 16 GM / H130	3440	4756						
TC 50 - ER 16 GM / H160	4018	4693						
TC 50 - ER 16 GM / H200	4019	4757						
TC 50 - ER 20 GM / H100	3010	4047	28	1 ÷ 13	0188	1230	5720	0787
TC 50 - ER 20 GM / H130	3441	4758						
TC 50 - ER 20 GM / H160	3419	4760						
TC 50 - ER 20 GM / H200	3012	4070						
TC 50 - ER 25 GM / H100	3016	4071	35	1 ÷ 16	0190	1231	5721	0996
TC 50 - ER 25 GM / H130	3024	4483						
TC 50 - ER 25 GM / H160	3420	4759						
TC 50 - ER 25 GM / H200	3025	4484						

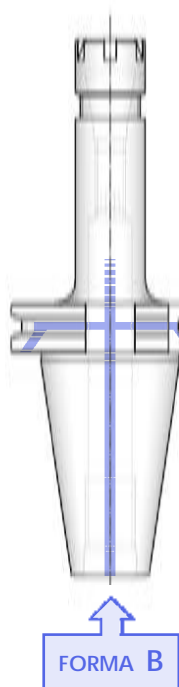
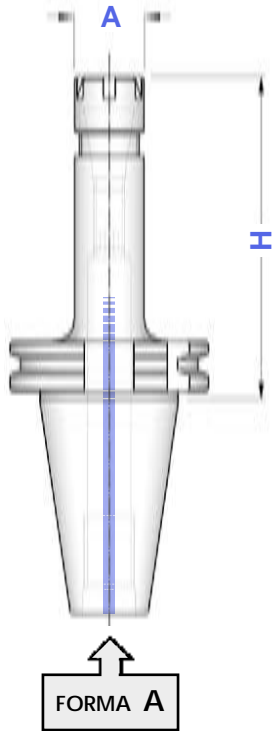





**DIN 69871****PORTAPINZE ER - GHIERA ESAGONALE**

ER - DIN 6499 COLLET CHUCKS WITH HEXAGONAL NUT

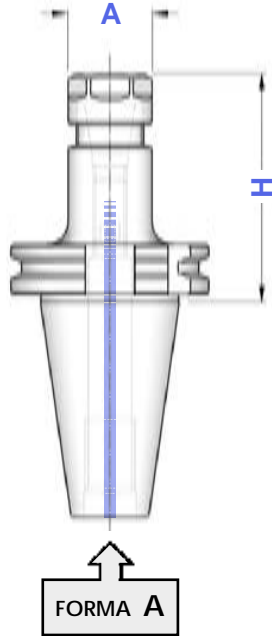
**FORMA A (AD)****FORMA B (AD+B)**

Balanced	G 6,3
≤ H100	12.000 rpm
> H100	8.000 rpm



TIPO	FORMA	FORMA	A	CAPACITA'				
	A	B						
TC 30 - ER 16 GE / H 55 TC 30 - ER 16 GE / H 100	8048 8049	—	28	1 ÷ 10	0183	1214	2906	0364
TC 30 - ER 20 GE / H 55 TC 30 - ER 20 GE / H 100	8050 8051	—	34	1 ÷ 13	0183	1215	2907	0787
TC 40 - ER 11 GE / H 70 TC 40 - ER 11 GE / H 100 TC 40 - ER 11 GE / H 130 TC 40 - ER 11 GE / H 160	3336 3337 3338 3339	4725 4726 4727 4728	19	1 ÷ 7	0181	1157	2905	5573
TC 40 - ER 16 GE / H 70 TC 40 - ER 16 GE / H 100 TC 40 - ER 16 GE / H 130 TC 40 - ER 16 GE / H 160 TC 40 - ER 16 GE / H 200	8052 8053 8054 8055 8056	8068 8069 8070 8071 8072	28	1 ÷ 10	0186	1214	2906	0364
TC 40 - ER 20 GE / H 70 TC 40 - ER 20 GE / H 100 TC 40 - ER 20 GE / H 130 TC 40 - ER 20 GE / H 160 TC 40 - ER 20 GE / H 200	8057 8058 8059 8060 8061	8073 8074 8075 8076 8077	34	1 ÷ 13	0188	1215	2907	0787
TC 50 - ER 16 GE / H 100 TC 50 - ER 16 GE / H 160 TC 50 - ER 16 GE / H 200	8062 8063 8064	8078 8079 8080	28	1 ÷ 10	0186	1214	2906	0364
TC 50 - ER 20 GE / H 100 TC 50 - ER 20 GE / H 160 TC 50 - ER 20 GE / H 200	8065 8066 8067	8081 8082 8083	34	1 ÷ 13	0188	1215	2907	0787

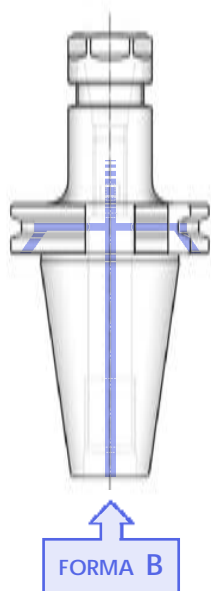





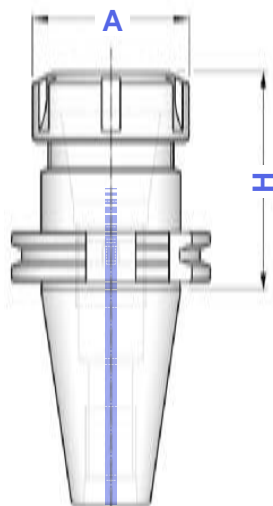
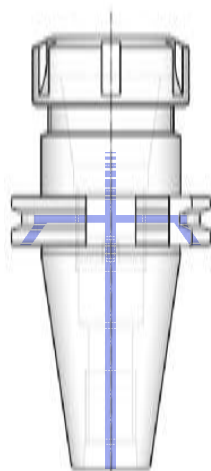

**DIN 69871****PORTAPINZE ER - GHIERA STANDARD**  
ER - DIN 6499 COLLET CHUCKS WITH STANDARD NUT**FORMA A (AD)****FORMA B (AD+B)**

Balanced	G 6,3
≤ H100	12.000 rpm
> H100	8.000 rpm

**FORMA A****FORMA B**

TIPO	FORMA A	FORMA B	A	CAPACITA'				
	Art.	Art.						
TC 30 - ER 16/H 55 TC 30 - ER 16/H 100	3442 3373	—	32	1 ÷ 10	0183	4993	3698	0364
TC 30 - ER 20/H 55 TC 30 - ER 20/H 100	0138 3374	—	35	1 ÷ 13	0183	4994	3699	0787
TC 30 - ER 25/H 55 TC 30 - ER 25/H 100	3342 3375	—	42	1 ÷ 16	0190	4995	3669	0996
TC 30 - ER 32/H 60 TC 30 - ER 32/H 100	3343 3376	—	50	2 ÷ 20	0190	4996	3670	0988
TC 40 - ER 16/H 70 TC 40 - ER 16/H 100 TC 40 - ER 16/H 130 TC 40 - ER 16/H 160 TC 40 - ER 16/H 200	3443 3444 3098 3445 3446	4700 4701 4754 4702 4755	32	1 ÷ 10	0186	4993	3698	0364
TC 40 - ER 20/H 70 TC 40 - ER 20/H 100 TC 40 - ER 20/H 130 TC 40 - ER 20/H 160 TC 40 - ER 20/H 200	3344 0140 3099 3100 3104	4703 4704 4830 4705 4831	35	1 ÷ 13	0188	4994	3699	0787
TC 40 - ER 25/H 70 TC 40 - ER 25/H 100 TC 40 - ER 25/H 130 TC 40 - ER 25/H 160 TC 40 - ER 25/H 200	3345 0141 0142 0146 3105	4706 4707 4708 4709 4832	42	1 ÷ 16	0190	4995	3669	0996
TC 40 - ER 32/H 70 TC 40 - ER 32/H 100 TC 40 - ER 32/H 130 TC 40 - ER 32/H 160 TC 40 - ER 32/H 200	3346 3347 3101 3348 3102	4710 4711 4712 4713 4076	50	2 ÷ 20	0191	4996	3670	0988
TC 40 - ER 40/H 70 TC 40 - ER 40/H 100 TC 40 - ER 40/H 130 TC 40 - ER 40/H 160 TC 40 - ER 40/H 200	3349 3350 3351 0153 3103	4714 4715 4716 4717 4718	63	3 ÷ 30	0195	4997	3671	0821
TC 40 - ER 50/H 85	0154	4719	78	6 ÷ 34	0191	4998	3668	4055
TC 45 - ER 32/H 70 TC 45 - ER 32/H 100 TC 45 - ER 32/H 130 TC 45 - ER 32/H 160 TC 45 - ER 32/H 200	3353 3106 3354 0184 3107	—	50	2 ÷ 20	0191	4996	3670	0988
TC 45 - ER 40/H 80	3355	—	63	3 ÷ 30	0195	4997	3671	0821
TC 50 - ER 16/H 100 TC 50 - ER 16/H 160 TC 50 - ER 16/H 200	3451 3452 3453	4731 4732 4806	32	1 ÷ 10	0186	4993	3698	0364
TC 50 - ER 20/H 100 TC 50 - ER 20/H 160 TC 50 - ER 20/H 200	3110 3111 3112	4733 4734 4807	35	1 ÷ 13	0188	4994	3699	0787
TC 50 - ER 25/H 70 TC 50 - ER 25/H 100 TC 50 - ER 25/H 160 TC 50 - ER 25/H 200	3360 0193 0199 3372	4735 4736 4737 4808	42	1 ÷ 16	0190	4995	3669	0996



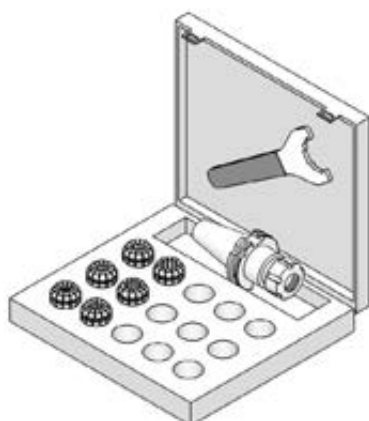

segue ➡

TIPO	FORMA	FORMA	A	CAPACITA'				
	A	B						
TC 50 - ER 32/H 70	<b>3900</b>	<b>4738</b>	50	2 ÷ 20	0191	4996	3670	0988
TC 50 - ER 32/H 100	<b>3361</b>	<b>4739</b>						
TC 50 - ER 32/H 130	<b>3362</b>	<b>4740</b>						
TC 50 - ER 32/H 160	<b>3363</b>	<b>4741</b>						
TC 50 - ER 32/H 200	<b>3364</b>	<b>4742</b>						
TC 50 - ER 32/H 250	<b>3382</b>	<b>4809</b>						
TC 50 - ER 40/H 80	<b>3901</b>	<b>4743</b>	63	3 ÷ 30	0195	4997	3671	0821
TC 50 - ER 40/H 100	<b>3365</b>	<b>4744</b>						
TC 50 - ER 40/H 130	<b>3366</b>	<b>4745</b>						
TC 50 - ER 40/H 160	<b>3367</b>	<b>4746</b>						
TC 50 - ER 40/H 200	<b>3368</b>	<b>4747</b>						
TC 50 - ER 50/H 100	<b>3369</b>	<b>4810</b>						
TC 50 - ER 50/H 160	<b>8044</b>	<b>8045</b>						

**CASSETTE CON SERIE RIDOTTA  
DI PINZE ER, MANDRINO FORMA A E CHIAVE**  
*EQUIPMENT BOXES WITH REDUCED SET OF ER COLLETS*







**FORMA  
A**

TIPO	Art.				
KIT Rid TC 30/H 55 - ER 25	<b>7770</b>	3342	3695	3669	0996: Ø 4 - 6 - 8 - 10 - 12 - 16
KIT Rid TC 30/H 60 - ER 32	<b>7771</b>	3343	3695	3670	0988: Ø 4 - 6 - 8 - 10 - 12 - 16 - 20
KIT Rid TC 40/H 70 - ER 25	<b>7772</b>	3345	3695	3669	0996: Ø 4 - 6 - 8 - 10 - 12 - 16
KIT Rid TC 40/H 70 - ER 32	<b>7773</b>	3346	3695	3670	0988: Ø 4 - 6 - 8 - 10 - 12 - 16 - 20
KIT Rid TC 40/H 70 - ER 40	<b>7774</b>	3349	3695	3671	0821: Ø 4 - 6 - 8 - 10 - 12 - 16 - 20 - 25
KIT Rid TC 50/H 70 - ER 32	<b>7775</b>	3900	3695	3670	0988: Ø 4 - 6 - 8 - 10 - 12 - 16 - 20
KIT Rid TC 50/H 80 - ER 40	<b>7776</b>	3901	3695	3671	0821: Ø 4 - 6 - 8 - 10 - 12 - 16 - 20 - 25

**CASSETTE CON SERIE COMPLETA  
DI PINZE ER, MANDRINO FORMA A E CHIAVE**  
*EQUIPMENT BOXES WITH COMPLETE SET OF ER COLLETS*



**FORMA  
A**

TIPO	Art.				
KIT TC 30/H 55 - ER25	<b>7777</b>	3342	3695	3669	0996: Ø 2 ÷ 16 (15 Pinze)
KIT TC 30/H 60 - ER32	<b>7778</b>	3343	3695	3670	0988: Ø 3 ÷ 20 (18 Pinze)
KIT TC 40/H 70 - ER25	<b>7779</b>	3345	3695	3669	0996: Ø 2 ÷ 16 (15 Pinze)
KIT TC 40/H 70 - ER32	<b>7780</b>	3346	3695	3670	0988: Ø 3 ÷ 20 (18 Pinze)
KIT TC 40/H 70 - ER40	<b>7781</b>	3349	3695	3671	0821: Ø 4 ÷ 26 (23 Pinze)
KIT TC 50/H 70 - ER32	<b>7782</b>	3900	3695	3670	0988: Ø 3 ÷ 20 (18 Pinze)
KIT TC 50/H 80 - ER40	<b>7783</b>	3901	3695	3671	0821: Ø 4 ÷ 26 (23 Pinze)

**DIN 69871****PORTAPINZE ER - GHIERA RALLA GIREVOLE**

ER - DIN 6499 COLLET CHUCKS WITH ROTARY RING NUT

**FORMA A (AD)****FORMA B (AD+B)**

Balanced	G 6,3
≤ H100	12.000 rpm
> H100	8.000 rpm

**GHIERA con RALLA GIREVOLE****CARATTERISTICHE E VANTAGGI**

- Aumenta sensibilmente la forza di serraggio della pinza.
- Evita la torsione della pinza riducendone l'attrito con la sua sede e conseguentemente ne preserva la precisione.
- E' intercambiabile con le normali ghiera standard ed esagonali.

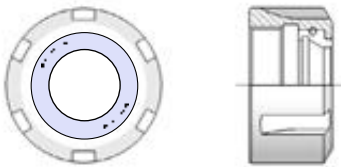
**ROTARY RING NUT****CHARACTERISTICS AND ADVANTAGES**

- Collet clamping force is sensitively increased.
- Avoids collet torsion reducing friction with its seat and consequently preserves its accuracy.
- Is interchangeable with standard and hexagonal nuts.

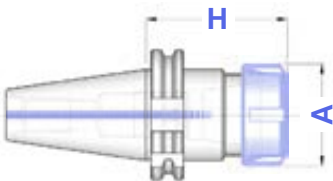

**FORMA A**  
CON GHIERA GC

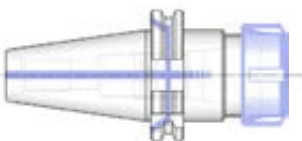

**FORMA B**  
CON GHIERA GC

TIPO	FORMA	FORMA	A	CAPACITA'				
	A	B						
TC 30 - ER 16 GC/H 55	<b>8120</b>	---	32	1 ÷ 10	0183	4954	3698	0364
TC 30 - ER 16 GC/H 100	<b>8121</b>	---						
TC 30 - ER 20 GC/H 55	<b>8122</b>	---	35	1 ÷ 13	0183	4955	3699	0787
TC 30 - ER 20 GC/H 100	<b>8123</b>	---						
TC 30 - ER 25 GC/H 55	<b>8124</b>	---	42	1 ÷ 16	0190	3697	3669	0996
TC 30 - ER 25 GC/H 100	<b>8125</b>	---						
TC 30 - ER 32 GC/H 60	<b>8126</b>	---	50	2 ÷ 20	0190	2911	3670	0988
TC 30 - ER 32 GC/H 100	<b>8127</b>	---						
TC 40 - ER 16 GC/H 70	<b>8128</b>	<b>8177</b>	32	1 ÷ 10	0186	4954	3698	0364
TC 40 - ER 16 GC/H 100	<b>8129</b>	<b>8178</b>						
TC 40 - ER 16 GC/H 130	<b>8130</b>	<b>8179</b>						
TC 40 - ER 16 GC/H 160	<b>8131</b>	<b>8180</b>						
TC 40 - ER 16 GC/H 200	<b>8132</b>	<b>8181</b>						
TC 40 - ER 20 GC/H 70	<b>8133</b>	<b>8182</b>						
TC 40 - ER 20 GC/H 100	<b>8134</b>	<b>8183</b>	35	1 ÷ 13	0188	4955	3699	0787
TC 40 - ER 20 GC/H 130	<b>8135</b>	<b>8184</b>						
TC 40 - ER 20 GC/H 160	<b>8136</b>	<b>8185</b>						
TC 40 - ER 20 GC/H 200	<b>8137</b>	<b>8186</b>						
TC 40 - ER 25 GC/H 70	<b>8138</b>	<b>8187</b>						
TC 40 - ER 25 GC/H 100	<b>8139</b>	<b>8188</b>						
TC 40 - ER 25 GC/H 130	<b>8140</b>	<b>8189</b>	42	1 ÷ 16	0190	3697	3669	0996
TC 40 - ER 25 GC/H 160	<b>8141</b>	<b>8190</b>						
TC 40 - ER 25 GC/H 200	<b>8142</b>	<b>8191</b>						
TC 40 - ER 32 GC/H 70	<b>8143</b>	<b>8192</b>						
TC 40 - ER 32 GC/H 100	<b>8144</b>	<b>8193</b>						
TC 40 - ER 32 GC/H 130	<b>8145</b>	<b>8194</b>						
TC 40 - ER 32 GC/H 160	<b>8146</b>	<b>8195</b>	50	2 ÷ 20	0191	2911	3670	0988
TC 40 - ER 32 GC/H 200	<b>8147</b>	<b>8196</b>						
TC 40 - ER 40 GC/H 70	<b>8148</b>	<b>8197</b>						
TC 40 - ER 40 GC/H 100	<b>8149</b>	<b>8198</b>						
TC 40 - ER 40 GC/H 130	<b>8150</b>	<b>8199</b>						
TC 40 - ER 40 GC/H 160	<b>8151</b>	<b>8200</b>						
TC 40 - ER 40 GC/H 200	<b>8152</b>	<b>8201</b>	63	3 ÷ 30	0195	2912	3671	0821
TC 50 - ER 16 GC/H 100	<b>8154</b>	<b>8203</b>						
TC 50 - ER 16 GC/H 160	<b>8155</b>	<b>8204</b>						
TC 50 - ER 16 GC/H 200	<b>8156</b>	<b>8205</b>						
TC 50 - ER 20 GC/H 100	<b>8157</b>	<b>8206</b>						
TC 50 - ER 20 GC/H 160	<b>8158</b>	<b>8207</b>						
TC 50 - ER 20 GC/H 200	<b>8159</b>	<b>8208</b>	42	1 ÷ 16	0190	3697	3669	0996
TC 50 - ER 25 GC/H 70	<b>8160</b>	<b>8209</b>						
TC 50 - ER 25 GC/H 100	<b>8161</b>	<b>8210</b>						
TC 50 - ER 25 GC/H 160	<b>8162</b>	<b>8211</b>						
TC 50 - ER 25 GC/H 200	<b>8163</b>	<b>8212</b>						
TC 50 - ER 32 GC/H 70	<b>8164</b>	<b>8213</b>						
TC 50 - ER 32 GC/H 100	<b>8165</b>	<b>8214</b>	50	2 ÷ 20	0191	2911	3670	0988
TC 50 - ER 32 GC/H 130	<b>8166</b>	<b>8215</b>						
TC 50 - ER 32 GC/H 160	<b>8167</b>	<b>8216</b>						
TC 50 - ER 32 GC/H 200	<b>8168</b>	<b>8217</b>						
TC 50 - ER 32 GC/H 250	<b>8169</b>	<b>8218</b>						
TC 50 - ER 40 GC/H 80	<b>8170</b>	<b>8219</b>						
TC 50 - ER 40 GC/H 100	<b>8171</b>	<b>8220</b>	63	3 ÷ 30	0195	2912	3671	0821
TC 50 - ER 40 GC/H 130	<b>8172</b>	<b>8221</b>						
TC 50 - ER 40 GC/H 160	<b>8173</b>	<b>8222</b>						
TC 50 - ER 40 GC/H 200	<b>8174</b>	<b>8223</b>						

# DIN 69871

## PORTA MANDRINI CON ATTACCO TRAPEZIO DIN 6327 AUTOMOTIVE SHANKS HOLDERS ACCORDING TO DIN 6327

### FORMA A (AD)

Balanced G 6,3  
8.000 rpm

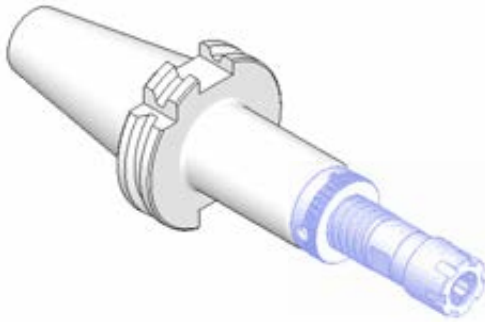

### FORMA A

TIPO	Art.	D	H	E	
TC 40 - TR20	3945	20	70	32	0020
TC 40 - TR28	3946	28	70	40	0021
TC 40 - TR36	3947	36	120	50	0021
TC 45 - TR20	3948	20	70	32	0020
TC 45 - TR28	3949	28	70	40	0021
TC 45 - TR36	3950	36	100	50	0021
TC 50 - TR28	3951	28	100	40	0021
TC 50 - TR36	3952	36	100	50	0021
TC 50 - TR48	3953	48	105	67	0060

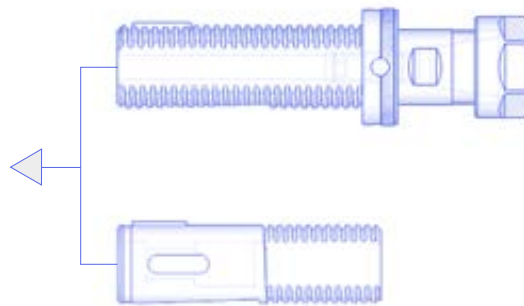
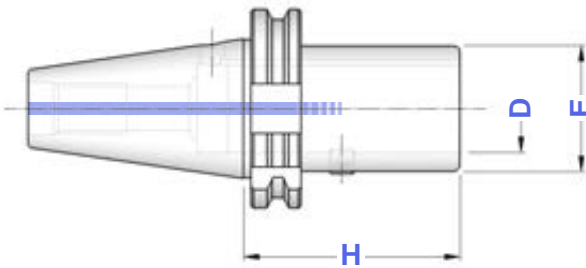

# DIN 69871

## MANDRINI PER PINZE EOC DIN 6388 DIN 6388 COLLET CHUCKS

### FORMA B (AD+B)

Balanced G 6,3  
≤ H100 12.000 rpm  
> H100 8.000 rpm

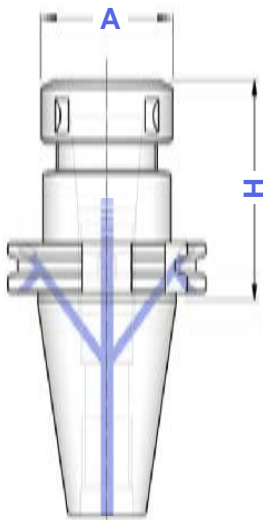



### FORMA B

TIPO	Art.	A	CAPACITA'			
TC 40 - EOC 16/H 70	8693	43	2 ÷ 16	4067	2883	0768
TC 40 - EOC 16/H 100	8694					
TC 40 - EOC 16/H 130	8695					
TC 40 - EOC 25/H 70	8696	60	2 ÷ 25	4068	2909	0769
TC 40 - EOC 25/H 100	8697					
TC 40 - EOC 25/H 130	8698					
TC 40 - EOC 32/H 80	8699	72	3 ÷ 32	4069	2910	0770
TC 50 - EOC 16/H 70	8700	43	2 ÷ 16	4067	2883	0768
TC 50 - EOC 16/H 100	8701					
TC 50 - EOC 25/H 70	8702	60	2 ÷ 25	4068	2909	0769
TC 50 - EOC 25/H 100	8703					
TC 50 - EOC 25/H 130	8704					
TC 50 - EOC 32/H 80	8705	72	3 ÷ 32	4069	2910	0770
TC 50 - EOC 32/H 130	8706					

**DIN 69871****MANDRINI A FORTE SERRAGGIO**  
HIGH GRIP CHUCKS**FORMA A (AD)****FORMA B (AD+B)**

Balanced G 6,3

12.000 rpm

TIPO	FORMA A	FORMA B	D	E		
	Art.	Art.				
TC 40 - PC 20/H 80	5110	5222	20	54	2900	0809
TC 40 - PC 20/H 105	3241	—				
TC 40 - PC 32/H 90	5111	5223	32	74	2910	0810
TC 40 - PC 32/H 105	3242	—				
TC 40 - PC 32/H 135	5103	—				
TC 50 - PC 20/H 80	5112	5225	20	54	2900	0809
TC 50 - PC 20/H 105	3243	—				
TC 50 - PC 32/H 90	5113	5226	32	74	2910	0810
TC 50 - PC 32/H 105	3244	—				
TC 50 - PC 32/H 135	5106	—				

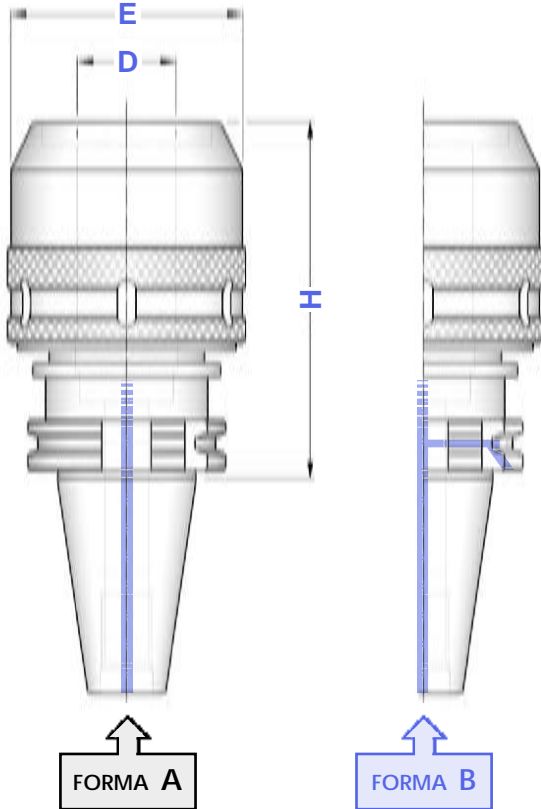
**CASSETTE CON MANDRINO  
CHIAVE E PINZE**EQUIPMENT BOXES WITH COLLET CHUCK  
WRENCH AND COLLETS**FORMA A**

TIPO	Art.				
KIT TC 40 - PC 20 / H 80	7543	5110	3695	2900	0809 ø 6 - 8 - 10 - 12 - 16
KIT TC 40 - PC 20 / H 105	7704	3241			
KIT TC 40 - PC 32 / H 90	7544	5111	3695	2910	0810 ø 6 - 8 - 10 - 12 - 16 - 20 - 25
KIT TC 40 - PC 32 / H 105	7707	3242			
KIT TC 50 - PC 20 / H 80	7545	5112	3695	2900	0809 ø 6 - 8 - 10 - 12 - 16
KIT TC 50 - PC 20 / H 105	7708	3243			
KIT TC 50 - PC 32 / H 90	7546	5113	3695	2910	0810 ø 6 - 8 - 10 - 12 - 16 - 20 - 25
KIT TC 50 - PC 32 / H 105	7711	3244			



**DIN 69871****MANDRINI A SERRAGGIO IDRAULICO****TIPO CORTO**

SHORT TYPE HYDRAULIC CHUCKS

**FORMA B (AD+B)**

Balanced G 2,5

20.000 rpm

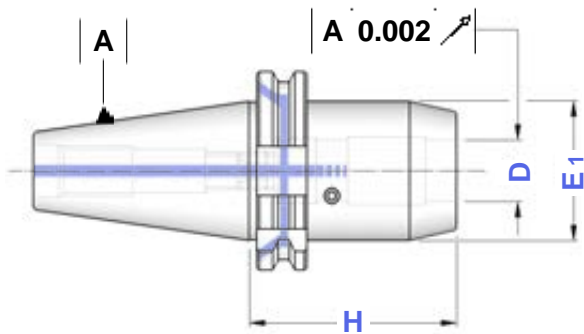
**FORMA  
B**

TIPO	Art.	D	H	E1	
TC 40 - HYDRO 20	5150	20	64	49,5	0521
TC 50 - HYDRO 32	5160	32	81	72,0	0522

**DIN 69871****MANDRINI A SERRAGGIO IDRAULICO****TIPO ALLEGGERITO**

RELIEVED TYPE HYDRAULIC CHUCKS

**FORMA B (AD+B)**

Balanced G 2,5

20.000 rpm

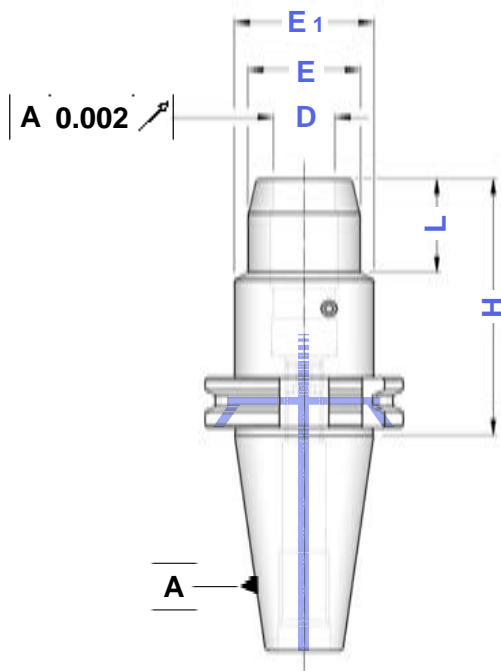
**FORMA  
B**

TIPO	Art.	D	H	E	E1	L
TC 40 - HYDRO 6/H 80	5151	6	80	26	49,5	29,5
TC 40 - HYDRO 8/H 80	5152	8	80	28	49,5	30,0
TC 40 - HYDRO 10/H 80	5153	10	80	30	49,5	35,0
TC 40 - HYDRO 12/H 80	5154	12	80	32	49,5	40,0
TC 40 - HYDRO 16/H 80	5155	16	80	38	49,5	45,0
TC 40 - HYDRO 20/H 80	5156	20	80	42	49,5	47,0
TC 40 - HYDRO 25/H 80	5157	25	80	55	63,0	28,0
TC 40 - HYDRO 32/H 80	5158	32	80	63	70,0	25,5
TC 50 - HYDRO 6/H 80	8995	6	80	26	49,5	29,5
TC 50 - HYDRO 8/H 80	8996	8	80	28	49,5	30,0
TC 50 - HYDRO 10/H 80	8997	10	80	30	49,5	35,0
TC 50 - HYDRO 12/H 80	8998	12	80	32	49,5	40,0
TC 50 - HYDRO 16/H 80	8999	16	80	38	49,5	45,0
TC 50 - HYDRO 20/H 80	5161	20	80	42	49,5	42,0
TC 50 - HYDRO 25/H 100	5021	25	100	55	63,0	48,0
TC 50 - HYDRO 32/H 100	5162	32	100	63	70,0	61,0

**Applicazioni:** consente il bloccaggio ad alta precisione di utensili a gambo cilindrico DIN 1835 Forma A e B, con tolleranza di gambo h 6 e rugosità Ra < 0,3 micron

**Attenzione:** non azionare il sistema idraulico se l'utensile non è inserito nel mandrino

**Applications:** allows high precision locking of DIN 1835 shank tools Form A and B, with shank tolerance h 6 and surface roughness Ra < 0,3 micron.

**Warning:** do not start Hydraulic System without any tool fit inside

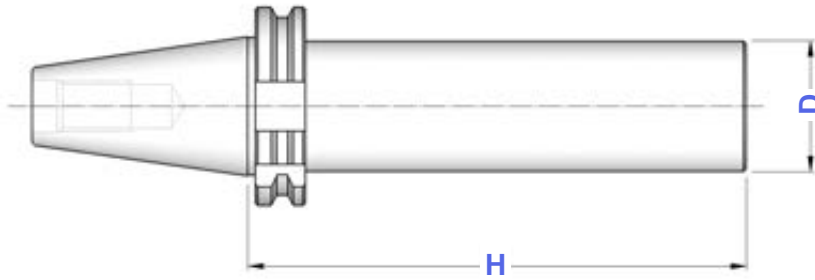
**DIN 69871****BARRE A STELO TENERO**  
BLANK BARS**FORMA A****FORMA  
A**

TIPO	Art.	H	D
TC 40 - D. 40	4355	160	40
TC 40 - D. 50	4356	200	50
TC 40 - D. 63	4357	250	63
TC 50 - D. 40	4362	160	40
TC 50 - D. 50	4363	250	50
TC 50 - D. 63	4364	250	63
TC 50 - D. 80	4365	300	80

**BARRE DI CONTROLLO**  
TEST ARBORS

TIPO	Art.	H	D
CONO 40 - D. 40 SC	2225	300	40
CONO 50 - D. 50 SC	2229	350	50

**Tolleranze della barra**

- Rettilineità = 0,003
- Rotondità in rotazione = 0,003
- Cilindricità = 0,003

*Bars tolerance*

- Straightnes = 0,003
- Runout accuracy = 0,003
- Cylindricity = 0,003

**Dati costruttivi**

- Costruite in acciaio da cementazione certificato
- Cementate con profondità 0,4 - 0,5 mm
- Temperate, rinvenute, brunite
- Durezza HRC 58 ± 2, resistenza 800-1000 N/mm<sup>2</sup>
- Finitura di rettifica esterna
- Collaudate 100% con strumenti di misura certificati

*Constructive Features*

- Manufactured with casehardening steel
- Casehardened with depth 0,4 - 0,5 mm
- Hardened, tempered, black oxidized
- Hardnes HRC 58 ± 2, strenght 800-1000 N/mm<sup>2</sup>
- External grinding finish
- Tested 100% with certified measuring instruments

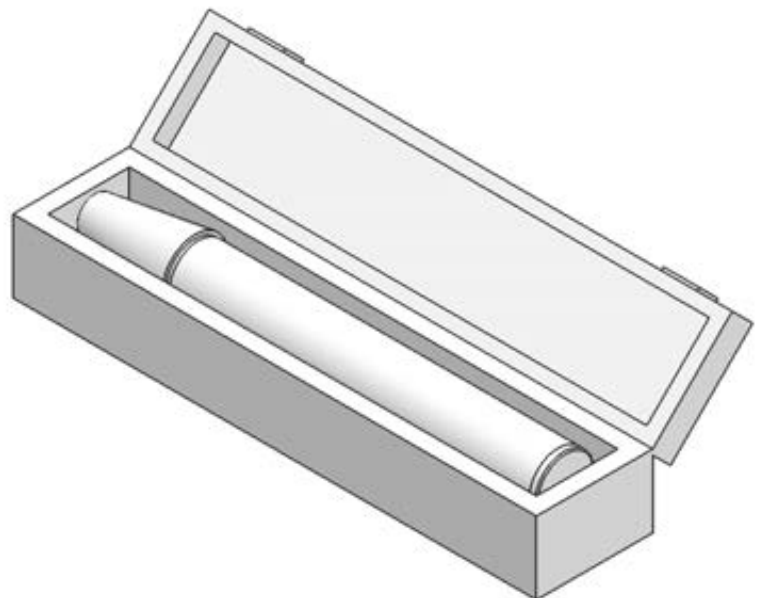

Balanced G 6,3  
12.000 rpm

TIPO	FORMA	FORMA	D	H	E	Fig.	G1	G2
	A	B						
	Art.	Art.						
TC 40 - WE 12/H 35	3079	8341	12	35	44	1	4973	—
TC 40 - WE 14/H 35	8338	8342	14	35	44	1	0390	—
TC 40 - WE 16/H 35	3080	2231	16	35	44	1	0068	—
TC 40 - WE 18/H 35	8339	8343	18	35	44	1	0261	—
TC 40 - WE 20/H 35	3081	2242	20	35	44	1	0070	—
TC 40 - WE 25/H 35	3082	2243	25	35	44	1	0076	—
TC 40 - WE 25/H 60	3015	4641		60	49	2	0076	0076
TC 40 - WE 32/H 40	3083	4642	32	40	44	1	0074	—
TC 40 - WE 32/H 70	4640	4643		70	72	2	0082	4977
TC 45 - WE 25/H 35	3085	—	25	35	57	1	0075	—
TC 50 - WE 16/H 35	3086	2234	16	35	70	1	4974	—
TC 50 - WE 18/H 35	8340	8344	18	35	70	1	4974	—
TC 50 - WE 20/H 35	3087	2237	20	35	70	1	4975	—
TC 50 - WE 25/H 35	3088	2251	25	35	70	1	4976	—
TC 50 - WE 32/H 35	3089	2252	32	35	70	1	4977	—
TC 50 - WE 40/H 35	3136	8345	40	35	70	1	0259	—

### WELDON EXTRACORTO

SHORT TYPE END MILL

Figura 1

### WELDON EXTRACORTO

SHORT TYPE END MILL

Figura 2

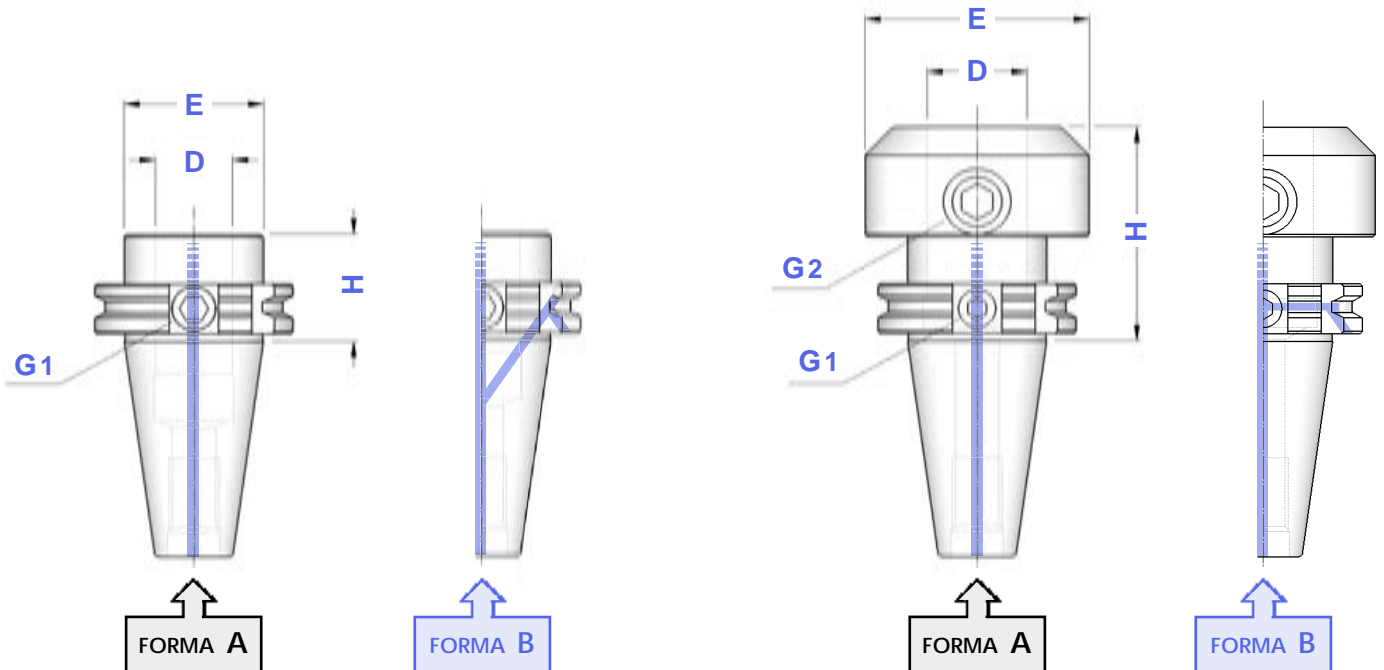



Balanced	G 6,3
≤ H100	12.000 rpm
> H100	8.000 rpm

Figura 1



Figura 2



TIPO	FORMA	FORMA	D	H	E	Fig.	Fig.
	A	B					
TC 30 - WE 6/H 45	3707	—	6	45	25	1	4970
TC 30 - WE 8/H 45	3708	—	8	45	28	1	4971
TC 30 - WE 10/H 50	3709	—	10	50	35	1	4972
TC 30 - WE 12/H 50	3710	—	12	50	42	1	4973
TC 30 - WE 16/H 70	3711	—	16	70	48	1	4974
TC 30 - WE 20/H 70	3712	—	20	70	52	1	4975
TC 40 - WE 6/H 50	3714	4761	6	50	25	1	4970
TC 40 - WE 6/H100	5001	5028		100			
TC 40 - WE 6/H130	5400	5416		130			
TC 40 - WE 6/H160	5519	5551		160			
TC 40 - WE 6/H200	4029	4144		200			
TC 40 - WE 8/H 50	3715	4762	8	50	28	1	4971
TC 40 - WE 8/H100	5002	5029		100			
TC 40 - WE 8/H130	5401	5417		130			
TC 40 - WE 8/H160	5520	5552		160			
TC 40 - WE 8/H200	4030	4146		200			
TC 40 - WE 10/H 50	3716	4763	10	50	35	1	4972
TC 40 - WE 10/H100	5003	5030		100			
TC 40 - WE 10/H130	5402	5418		130			
TC 40 - WE 10/H160	5521	5553		160			
TC 40 - WE 10/H200	4031	4148		200			
TC 40 - WE 12/H 50	3717	4764	12	50	42	1	4973
TC 40 - WE 12/H100	5004	5031		100			
TC 40 - WE 12/H130	5403	5419		130			
TC 40 - WE 12/H160	5524	5554		160			
TC 40 - WE 12/H200	4032	4150		200			
TC 40 - WE 14/H 50	3594	4765	14	50	44	1	4973
TC 40 - WE 14/H100	5005	5032		100			
TC 40 - WE 14/H130	4033	4155		130			
TC 40 - WE 14/H160	4034	4157		160			
TC 40 - WE 14/H200	4035	4158		200			
TC 40 - WE 16/H 63	3718	4766	16	63	48	1	4974
TC 40 - WE 16/H100	5006	5033		100			
TC 40 - WE 16/H130	5404	5420		130			
TC 40 - WE 16/H160	5007	5035		160			
TC 40 - WE 16/H200	4036	4159		200			
TC 40 - WE 18/H 63	3595	4767	18	63	50	1	4974
TC 40 - WE 18/H100	5008	5036		100			
TC 40 - WE 18/H130	4037	4160		130			
TC 40 - WE 18/H160	4038	4162		160			
TC 40 - WE 18/H200	4039	4163		200			
TC 40 - WE 20/H 63	3719	4768	20	63	52	1	4975
TC 40 - WE 20/H100	5010	5038		100			
TC 40 - WE 20/H130	5011	5039		130			
TC 40 - WE 20/H160	5012	5040		160			
TC 40 - WE 20/H200	4043	4164		200			
TC 40 - WE 25/H100	3720	4769	25	100	65	2	4976
TC 40 - WE 25/H130	5013	5041		130			
TC 40 - WE 25/H160	5014	5042		160			
TC 40 - WE 25/H200	4044	4166		200			
TC 40 - WE 32/H100	3721	4770	32	100	72	2	4977
TC 40 - WE 32/H130	5015	5043		130			
TC 40 - WE 32/H160	5016	5044		160			
TC 40 - WE 32/H200	4045	4168		200			
TC 40 - WE 40/H115	4457	4771	40	115	80	2	4977

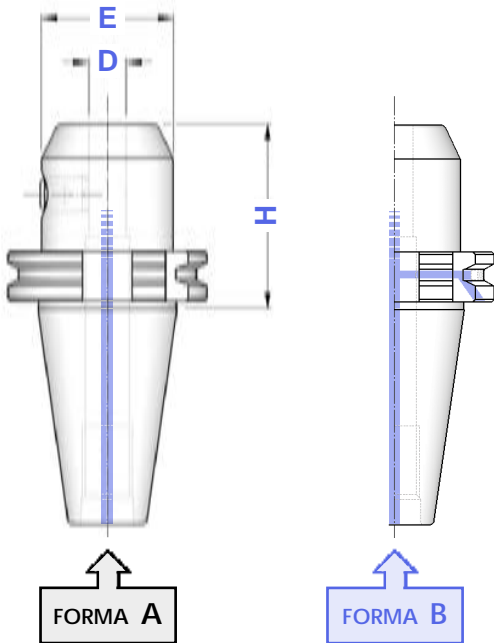
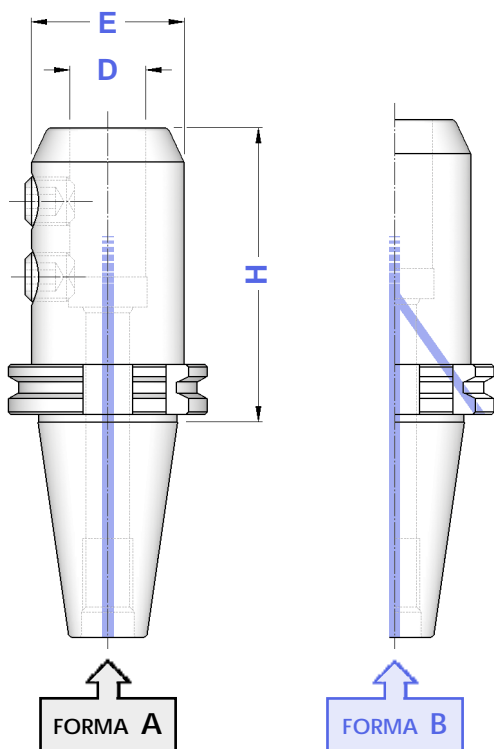
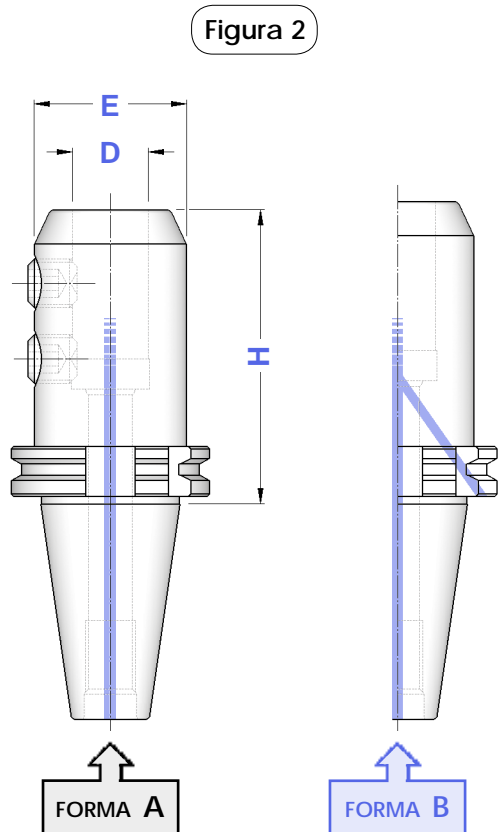
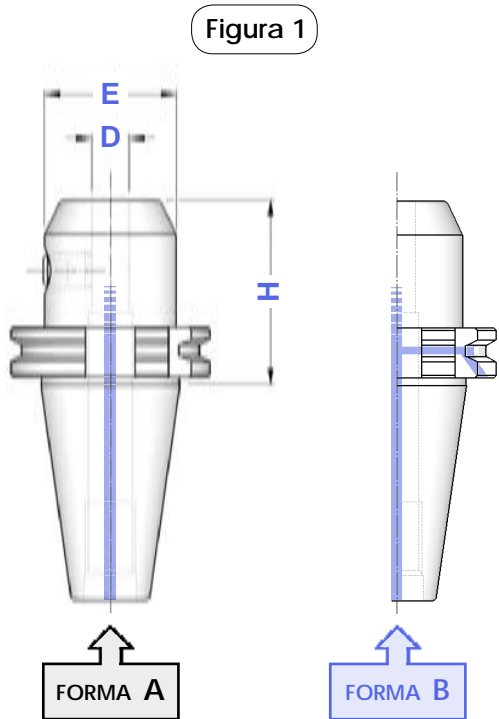

TIPO	FORMA	FORMA	D	H	E	Fig.	Art.
	A	B					
TC 45 - WE 6/H 63	3722	---	6	63	25	1	4970
TC 45 - WE 8/H 63	3723	---	8	63	28	1	4971
TC 45 - WE 10/H 63	3724	---	10	63	35	1	4972
TC 45 - WE 12/H 63	3725	---	12	63	42	1	4973
TC 45 - WE 16/H 63	3726	---	16	63	48	1	4974
TC 45 - WE 20/H 63	3727	---	20	63	52	1	4975
TC 45 - WE 25/H100	3728	---	25	100	65	2	4976
TC 45 - WE 32/H100	3729	---	32	100	72	2	4977
TC 45 - WE 40/H100	4515	---	40	100	80	2	4977
TC 50 - WE 6/H 63	3730	4783	6	63	25	1	4970
TC 50 - WE 6/H100	5017	5045		100			
TC 50 - WE 6/H130	5405	5426		130			
TC 50 - WE 6/H160	5525	5555		160			
TC 50 - WE 6/H200	4123	4173		200			
TC 50 - WE 8/H 63	3731	4784	8	63	28	1	4971
TC 50 - WE 8/H100	5018	5046		100			
TC 50 - WE 8/H130	5406	5427		130			
TC 50 - WE 8/H160	5526	5556		160			
TC 50 - WE 8/H200	4125	4175		200			
TC 50 - WE 10/H 63	3732	4785	10	63	35	1	4972
TC 50 - WE 10/H100	5019	5047		100			
TC 50 - WE 10/H130	5407	5428		130			
TC 50 - WE 10/H160	5527	5558		160			
TC 50 - WE 10/H200	4128	4177		200			
TC 50 - WE 12/H 63	3733	4786	12	63	42	1	4973
TC 50 - WE 12/H100	5528	5559		100			
TC 50 - WE 12/H130	5408	5429		130			
TC 50 - WE 12/H160	5020	5048		160			
TC 50 - WE 12/H200	4129	4179		200			
TC 50 - WE 14/H 63	4516	4787	14	63	44	1	4973
TC 50 - WE 14/H100	5529	5560		100			
TC 50 - WE 14/H130	4130	4182		130			
TC 50 - WE 14/H160	4132	4183		160			
TC 50 - WE 14/H200	4134	4204		200			
TC 50 - WE 16/H 63	3734	4788	16	63	48	1	4974
TC 50 - WE 16/H100	5534	5561		100			
TC 50 - WE 16/H130	5409	5430		130			
TC 50 - WE 16/H160	5022	5050		160			
TC 50 - WE 16/H200	4136	4206		200			
TC 50 - WE 18/H 63	4517	4789	18	63	50	1	4974
TC 50 - WE 18/H100	5535	5562		100			
TC 50 - WE 18/H130	4137	4213		130			
TC 50 - WE 18/H160	4138	4215		160			
TC 50 - WE 18/H200	4139	4236		200			
TC 50 - WE 20/H 63	3735	4790	20	63	52	1	4975
TC 50 - WE 20/H100	5536	5563		100			
TC 50 - WE 20/H130	5410	5431		130			
TC 50 - WE 20/H160	5024	5052		160			
TC 50 - WE 20/H200	4140	4242		200			
TC 50 - WE 25/H 80	3736	4791	25	80	65	2	4976
TC 50 - WE 25/H100	5413	5051		100			
TC 50 - WE 25/H130	5414	5432		130			
TC 50 - WE 25/H160	5025	5054		160			
TC 50 - WE 25/H200	4141	4244		200			
TC 50 - WE 32/H100	3737	4792	32	100	72	2	4977
TC 50 - WE 32/H130	5415	5433		130			
TC 50 - WE 32/H160	5026	5055		160			
TC 50 - WE 32/H200	4142	4245		200			
TC 50 - WE 40/H120	3738	4793	40	120	80	2	4977
TC 50 - WE 40/H160	5027	5056		160			
TC 50 - WE 50/H120	3739	4247	50	120	97	2	4978

**DIN 69871****PORTAFRESE WELDON CON SFERE DI LUBRIFICAZIONE**  
TOOLHOLDERS FOR DIN 1835-B SHANKS WITH FRONT COOLANT**FORMA B (AD+B)**

Balanced G 6,3

12.000 rpm

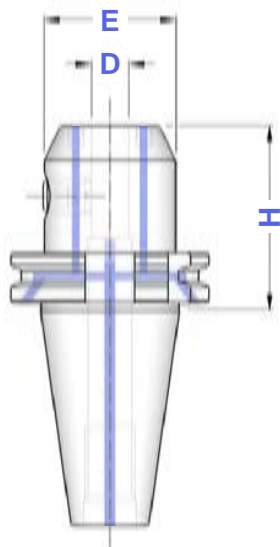
**FORMA B**

TIPO	Art.	D	H	E	
TC 40 - WEC 6/H 50	7850	6	50	25	4970
TC 40 - WEC 8/H 50	7851	8	50	28	4971
TC 40 - WEC 10/H 50	7852	10	50	35	4972
TC 40 - WEC 12/H 50	7853	12	50	42	4973
TC 40 - WEC 14/H 50	7854	14	50	44	4973
TC 40 - WEC 16/H 63	7855	16	63	48	4974
TC 40 - WEC 18/H 63	7856	18	63	50	4974
TC 40 - WEC 20/H 63	7857	20	63	52	4975
TC 40 - WEC 25/H 100	7858	25	100	65	4976
TC 40 - WEC 32/H 100	7859	32	100	72	4977
TC 40 - WEC 40/H 115	7860	40	115	80	4977
TC 50 - WEC 6/H 63	7861	6	63	25	4970
TC 50 - WEC 8/H 63	7862	8	63	28	4971
TC 50 - WEC 10/H 63	7863	10	63	35	4972
TC 50 - WEC 12/H 63	7864	12	63	42	4973
TC 50 - WEC 14/H 63	7865	14	63	44	4973
TC 50 - WEC 16/H 63	7866	16	63	48	4974
TC 50 - WEC 18/H 63	7867	18	63	50	4974
TC 50 - WEC 20/H 63	7868	20	63	52	4975
TC 50 - WEC 25/H 80	7869	25	80	65	4976
TC 50 - WEC 32/H 100	7870	32	100	72	4977
TC 50 - WEC 40/H 120	7871	40	120	80	4977

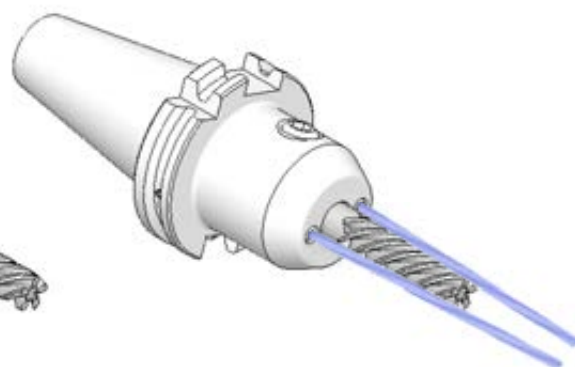
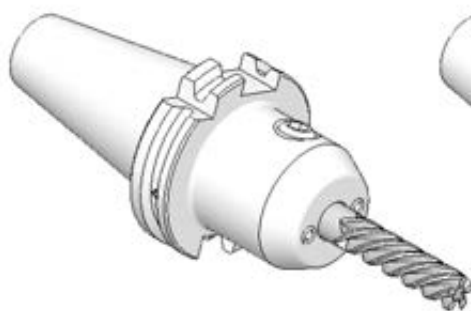
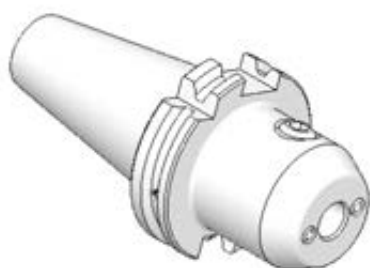

Balanced G 6,3  
12.000 rpm

FORMA  
B



Figura 1

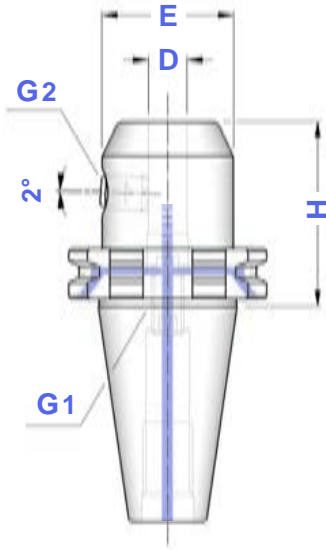

TIPO	Art.	D	H	E	Fig.	G1	G2
TC 40 - WN 6/ H 50	4795	6	50	25	1	0233	4970
TC 40 - WN 8/ H 50	4796	8	50	28	1	0235	4971
TC 40 - WN10/ H 50	4797	10	50	35	1	0238	4972
TC 40 - WN12/ H 50	4798	12	50	42	1	0240	4973
TC 40 - WN14/ H 50	4799	14	50	44	1	0240	4973
TC 40 - WN16/ H 63	4800	16	63	48	1	0245	4974
TC 40 - WN18/ H 63	4801	18	63	50	1	0245	4974
TC 40 - WN20/ H 63	4802	20	63	52	1	0245	4975
TC 40 - WN25/ H100	4803	25	100	65	2	0212	4976
TC 40 - WN32/ H100	4804	32	100	72	2	0212	4977
TC 40 - WN40/ H115	4805	40	115	80	2	0212	4977
TC 50 - WN 6/ H 63	4815	6	63	25	1	0233	4970
TC 50 - WN 8/ H 63	4816	8	63	28	1	0235	4971
TC 50 - WN10/ H 63	4817	10	63	35	1	0238	4972
TC 50 - WN12/ H 63	4818	12	63	42	1	0240	4973
TC 50 - WN14/ H 63	4819	14	63	44	1	0240	4973
TC 50 - WN16/ H 63	4820	16	63	48	1	0245	4974
TC 50 - WN18/ H 63	4821	18	63	50	1	0245	4974
TC 50 - WN20/ H 63	4822	20	63	52	1	0245	4975
TC 50 - WN25/ H 80	4823	25	80	65	2	0247	4976
TC 50 - WN32/ H100	4824	32	100	72	2	0247	4977
TC 50 - WN40/ H120	4825	40	120	80	2	0247	4977

Figura 2

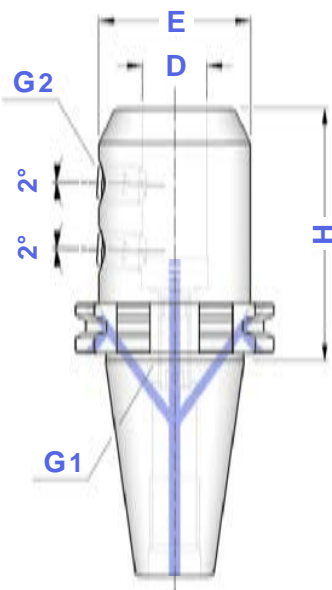

# DIN 69871

## RIDUZIONI A CONO MORSE PER PUNTE MORSE TAPER ADAPTERS FOR TWIST DRILLS DIN 228 FORM B SHANK

FORMA A

FORMA B

Balanced G 6,3  
8.000 rpm

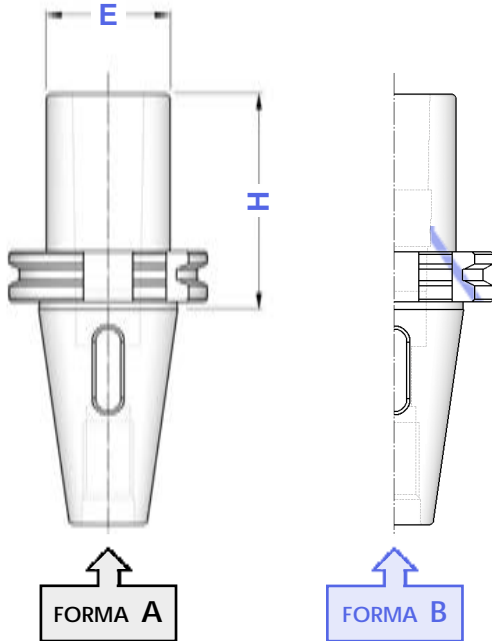

TIPO	FORMA A	FORMA B	CM	H	E
	Art.	Art.			
TC 30 - CM 1 PUNTE	3600	—	1	55	25
TC 30 - CM 2 PUNTE	3631	—	2	65	32
TC 30 - CM 3 PUNTE	3632	—	3	90	40
TC 40 - CM 1 PUNTE	3601	4826	1	50	25
TC 40 - CM 2 PUNTE	3602	4827	2	60	32
TC 40 - CM 3 PUNTE	3635	4828	3	70	40
TC 40 - CM 4 PUNTE	3636	4829	4	95	48
TC 45 - CM 1 PUNTE	3589	—	1	50	25
TC 45 - CM 2 PUNTE	3590	—	2	60	32
TC 45 - CM 3 PUNTE	3591	—	3	80	40
TC 45 - CM 4 PUNTE	3640	—	4	100	48
TC 50 - CM 1 PUNTE	3603	—	1	45	25
TC 50 - CM 2 PUNTE	3604	4835	2	60	32
TC 50 - CM 3 PUNTE	3605	4836	3	65	40
TC 50 - CM 4 PUNTE	3645	4837	4	95	48
TC 50 - CM 5 PUNTE	3646	4838	5	120	63

# DIN 69871

## RIDUZIONI A CONO MORSE PER FRESE MORSE TAPER ADAPTERS FOR MILLING CUTTERS DIN 228 FORM A SHANK

FORMA A

FORMA B

Balanced G 6,3  
8.000 rpm

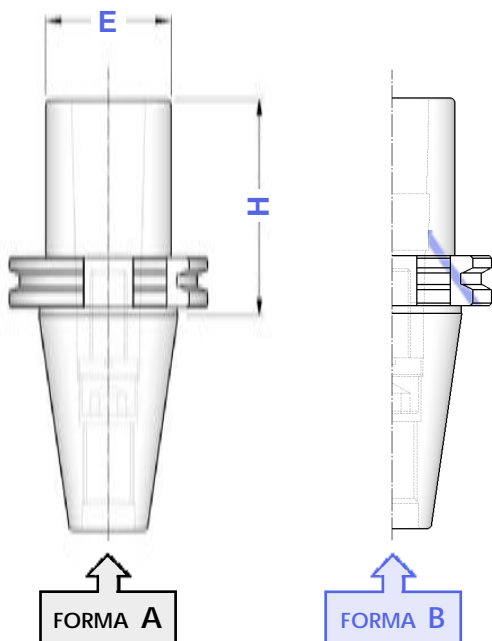

TIPO	FORMA A	FORMA B	CM	H	E			
	Art.	Art.						
TC 30 - CM 2 FRESE	3892	—	2	60	32	7448	7422	4569
TC 30 - CM 3 FRESE	3893	—	3	80	40	7402	7423	4570
TC 40 - CM 2 FRESE	3681	4840	2	50	32	7448	7422	4569
TC 40 - CM 3 FRESE	3894	4841	3	70	40	7403	7423	4570
TC 40 - CM 4 FRESE	3895	4842	4	95	48	7404	7424	4571
TC 45 - CM 4 FRESE	3896	—	4	110	48	7407	7424	4571
TC 50 - CM 2 FRESE	3666	4848	2	60	32	7448	7422	4569
TC 50 - CM 3 FRESE	3897	4849	3	65	40	7403	7423	4570
TC 50 - CM 4 FRESE	3898	4850	4	95	48	7407	7424	4571
TC 50 - CM 5 FRESE	3899	4851	5	120	63	7408	7425	4572

# DIN 69871

## RIDUZIONI A CONO MORSE PUNTE + FRESE COMBinate



COMBI MORSE TAPER ADAPTERS: TWIST DRILLS + MILLING CUTTERS

FORMA A

FORMA B

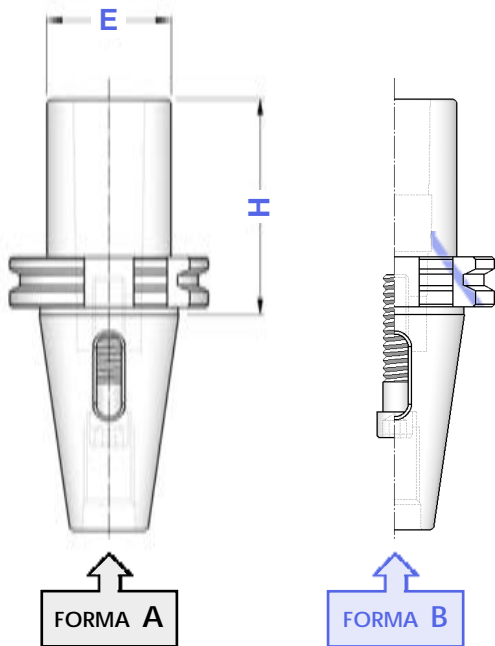
Balanced G 6,3  
8.000 rpm



TIPO	FORMA A	FORMA B	CM	H	E		
	Art.	Art.					
TC 30 - CM 1 P+F	3630	—	1	55	25	7415	—
TC 30 - CM 2 P+F	3606	—	2	65	32	7400	0276
TC 30 - CM 3 P+F	3608	—	3	90	40	7418	0130
TC 40 - CM 1 P+F	3633	8740	1	50	25	7400	—
TC 40 - CM 2 P+F	3634	8741	2	60	32	7401	—
TC 40 - CM 3 P+F	3607	8742	3	70	40	7400	0130
TC 45 - CM 1 P+F	3637	—	1	50	25	7400	—
TC 45 - CM 2 P+F	3638	—	2	60	32	7405	—
TC 45 - CM 3 P+F	3639	—	3	80	40	7455	—
TC 45 - CM 4 P+F	3641	—	4	100	48	0056	0129
TC 50 - CM 1 P+F	3642	—	1	45	25	7400	—
TC 50 - CM 2 P+F	3643	8743	2	60	32	7405	—
TC 50 - CM 3 P+F	3644	8744	3	65	40	7406	—
TC 50 - CM 4 P+F	3682	8745	4	95	48	7409	—
TC 50 - CM 5 P+F	3683	8746	5	120	63	7406	0131



# DIN 69871

## RIDUZIONI A CONO MORSE PER PUNTE E PUNTE + FRESE TIPO PROLUNGATO

EXTENDED MORSE TAPER ADAPTERS: TWIST DRILLS + MILLING CUTTERS

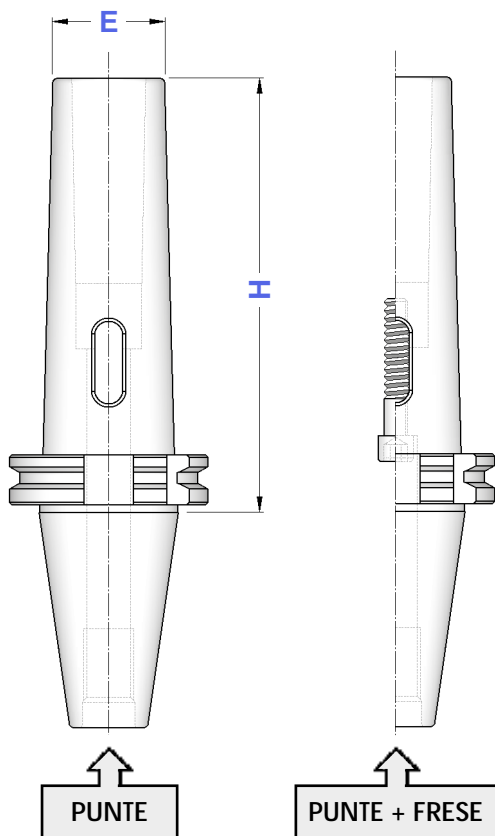
FORMA A



TIPO	PUNTE	PUNTE + FRESE	CM	H	E		
	Art.	Art.					
TC 40 - CM 1	3778	4238	1	115	18	7400	—
TC 40 - CM 2	3779	4239	2	125	25	7401	—
TC 40 - CM 3	3780	4240	3	140	33	7400	0130
TC 40 - CM 4	4241	—	4	165	40	—	—
TC 45 - CM 1	—	3684	1	120	18	7400	—
TC 45 - CM 2	—	3685	2	130	25	7405	—
TC 45 - CM 3	—	3686	3	140	33	7455	—
TC 45 - CM 4	—	3687	4	160	40	0056	0129
TC 50 - CM 1	3745	4248	1	120	18	7400	—
TC 50 - CM 2	3746	4249	2	140	25	7405	—
TC 50 - CM 3	3747	4250	3	150	33	7406	—
TC 50 - CM 4	3748	4251	4	180	40	7409	—
TC 50 - CM 5	3749	4252	5	220	55	0055	0131

# DIN 69871

## PORTAFRESE FISSI DIN 6357 FACE MILL HOLDERS

### FORMA A

Balanced G 6,3  
8.000 rpm

#### FORMA A

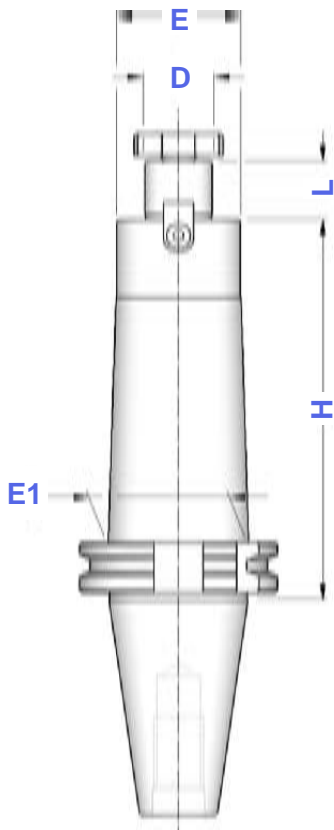
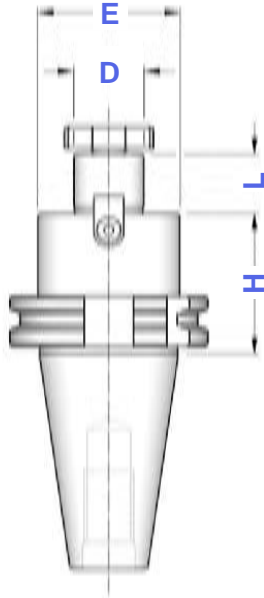
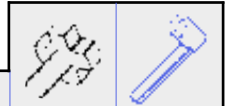

TIPO	Art.	D	L	E	E1		
TC 30 - D. 13 FISSO / H 35	3940	13	12	28	28	0482	—
TC 30 - D. 16 FISSO / H 35	4122	16	17	38	38	4985	4562
TC 30 - D. 22 FISSO / H 50	4124	22	19	48	48	4986	4563
TC 30 - D. 27 FISSO / H 50	4126	27	21	58	58	4987	4564
TC 30 - D. 32 FISSO / H 55	4143	32	24	58	58	4988	4565
TC 40 - D. 13 FISSO / H 45	8363	13	12	28	28	0482	—
TC 40 - D. 16 FISSO / H 45	4127	16	17	38	38	4985	4562
TC 40 - D. 16 FISSO / H 100	5537						
TC 40 - D. 16 FISSO / H 130	9400						
TC 40 - D. 16 FISSO / H 160	8364						
TC 40 - D. 16 FISSO / H 200	8365						
TC 40 - D. 22 FISSO / H 45	4652	22	19	48	48	4986	4563
TC 40 - D. 22 FISSO / H 100	5538						
TC 40 - D. 22 FISSO / H 130	9401						
TC 40 - D. 22 FISSO / H 160	5539						
TC 40 - D. 22 FISSO / H 200	8366						
TC 40 - D. 27 FISSO / H 50	4653	27	21	58	58	4987	4564
TC 40 - D. 27 FISSO / H 100	5540						
TC 40 - D. 27 FISSO / H 130	9402						
TC 40 - D. 27 FISSO / H 160	5541						
TC 40 - D. 27 FISSO / H 200	8367						
TC 40 - D. 32 FISSO / H 55	4654	32	24	78	78	4988	4565
TC 40 - D. 32 FISSO / H 100	5542						
TC 40 - D. 32 FISSO / H 160	8368						
TC 40 - D. 40 FISSO / H 55	4655	40	27	88	88	4989	4566
TC 40 - D. 40 FISSO / H 100	4694						
TC 40 - D. 40 FISSO / H 160	8369						
TC 50 - D. 16 FISSO / H 45	4661	16	17	38	38	4985	4562
TC 50 - D. 16 FISSO / H 100	4695						
TC 50 - D. 16 FISSO / H 130	9405						
TC 50 - D. 16 FISSO / H 160	8370						
TC 50 - D. 16 FISSO / H 200	8371						
TC 50 - D. 22 FISSO / H 45	4662	22	19	48	48	4986	4563
TC 50 - D. 22 FISSO / H 100	5544						
TC 50 - D. 22 FISSO / H 130	9406						
TC 50 - D. 22 FISSO / H 160	5545						
TC 50 - D. 22 FISSO / H 200	8372						
TC 50 - D. 22 FISSO / H 250	8373						
TC 50 - D. 22 FISSO / H 300	8374						
TC 50 - D. 27 FISSO / H 45	4663	27	21	58	58	4987	4564
TC 50 - D. 27 FISSO / H 100	5546						
TC 50 - D. 27 FISSO / H 130	9407						
TC 50 - D. 27 FISSO / H 160	5547						
TC 50 - D. 27 FISSO / H 200	8375						
TC 50 - D. 27 FISSO / H 250	8376						
TC 50 - D. 27 FISSO / H 300	8377						
TC 50 - D. 32 FISSO / H 50	4664	32	24	78	78	4988	4565
TC 50 - D. 32 FISSO / H 100	5548						
TC 50 - D. 32 FISSO / H 130	9408						
TC 50 - D. 32 FISSO / H 160	5549						
TC 50 - D. 32 FISSO / H 200	8378						
TC 50 - D. 32 FISSO / H 250	8379						
TC 50 - D. 32 FISSO / H 300	8380						
TC 50 - D. 40 FISSO / H 55	4665	40	27	88	88	4989	4566
TC 50 - D. 40 FISSO / H 100	5550						
TC 50 - D. 40 FISSO / H 160	8381						
TC 50 - D. 40 FISSO / H 200	8382						

# DIN 69871

## PORTAFRESE FISSI CON PASSAGGIO REFRIGERANTE

DIN 6357 FACE MILL HOLDERS WITH COOLANT THROUGH

FORMA B (AD+B)

Balanced G 6,3  
8.000 rpm

FORMA  
B

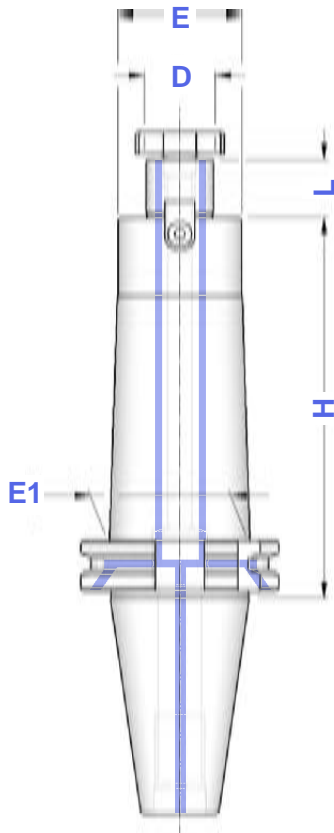
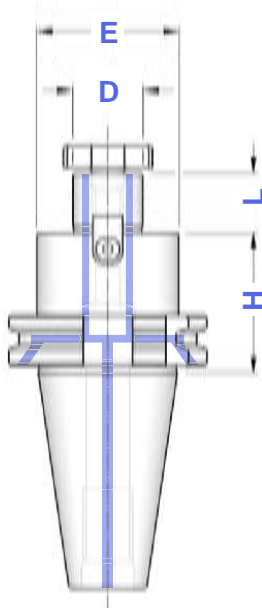

TIPO	Art.	D	L	E	E1			
TCB 40 - D.16 FISSO/H 45	5844	16	17	38	38	4985	4562	
TCB 40 - D.16 FISSO/H100	5845							
TCB 40 - D.16 FISSO/H130	9410							
TCB 40 - D.16 FISSO/H160	8385							
TCB 40 - D.16 FISSO/H200	8386							
TCB 40 - D.22 FISSO/H 45	5846	22	19	48	48	4986	4563	
TCB 40 - D.22 FISSO/H100	5847							
TCB 40 - D.22 FISSO/H130	9411			46				
TCB 40 - D.22 FISSO/H160	8387							
TCB 40 - D.22 FISSO/H200	8388							
TCB 40 - D.27 FISSO/H 50	5848	27	21	58	58	4987	4564	
TCB 40 - D.27 FISSO/H100	5849							
TCB 40 - D.27 FISSO/H130	9412			48				
TCB 40 - D.27 FISSO/H160	8389							
TCB 40 - D.27 FISSO/H200	8390							
TCB 40 - D.32 FISSO/H 55	5850	32	24	78	78	4988	4565	
TCB 40 - D.32 FISSO/H100	5851			58	58			
TCB 40 - D.32 FISSO/H160	8391							
TCB 40 - D.40 FISSO/H 55	5852	40	27	88	88	4989	4566	
TCB 40 - D.40 FISSO/H100	8392			70	70			
TCB 40 - D.40 FISSO/H160	8393							
TCB 50 - D.16 FISSO/H 45	5853	16	17	38	38	4985	4562	
TCB 50 - D.16 FISSO/H100	5854							
TCB 50 - D.16 FISSO/H130	9415							
TCB 50 - D.16 FISSO/H160	8394							
TCB 50 - D.16 FISSO/H200	8395							
TCB 50 - D.22 FISSO/H 45	5855	22	19	48	48	4986	4563	
TCB 50 - D.22 FISSO/H100	5856							
TCB 50 - D.22 FISSO/H130	9416			46				
TCB 50 - D.22 FISSO/H160	8396							
TCB 50 - D.22 FISSO/H200	8397							
TCB 50 - D.22 FISSO/H250	8398							
TCB 50 - D.22 FISSO/H300	8399							
TCB 50 - D.27 FISSO/H 45	5857	27	21	58	58	4987	4564	
TCB 50 - D.27 FISSO/H100	5858							
TCB 50 - D.27 FISSO/H130	9417			55				78
TCB 50 - D.27 FISSO/H160	8400							
TCB 50 - D.27 FISSO/H200	8401							
TCB 50 - D.27 FISSO/H250	8402							
TCB 50 - D.27 FISSO/H300	8403							
TCB 50 - D.32 FISSO/H 50	5859	32	24	78	78	4988	4565	
TCB 50 - D.32 FISSO/H100	5860			66				
TCB 50 - D.32 FISSO/H130	9418							
TCB 50 - D.32 FISSO/H160	8404							
TCB 50 - D.32 FISSO/H200	8405							
TCB 50 - D.32 FISSO/H250	8406							
TCB 50 - D.32 FISSO/H300	8407							
TCB 50 - D.40 FISSO/H 55	5861	40	27	88	88	4989	4566	
TCB 50 - D.40 FISSO/H100	5862			70	70			
TCB 50 - D.40 FISSO/H160	8408							
TCB 50 - D.40 FISSO/H200	8409							



# DIN 69871

## ATTACCHI PER FRESE AD INSERTI FACE MILL HOLDERS FOR FACE MILLING CUTTERS

### FORMA A

Balanced G 6,3

8.000 rpm

### FORMA A

TIPO	Art.	D	H	L	E	C	F
TC 40 - D. 40 FM	4181	40	60	30	89	66,7	M12
TC 50 - D. 40 FM	4184	40	70	30	89	66,7	M12
TC 50 - D. 60 FM	4185	60	70	40	129	101,6	M16

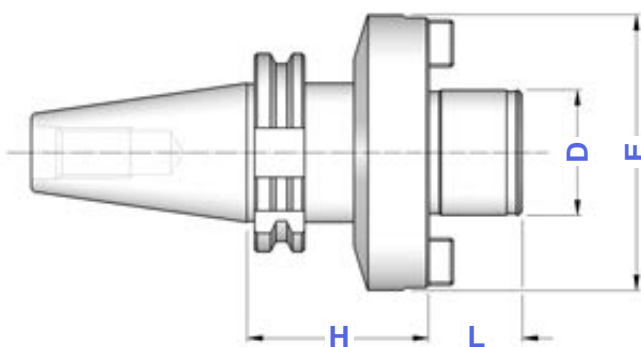
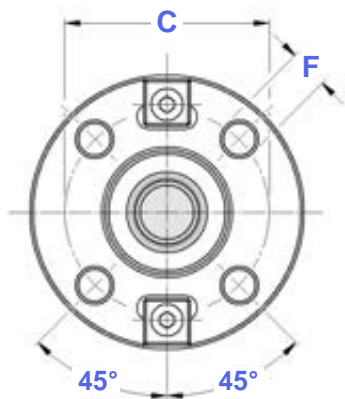



# DIN 69871

## PORTAFRESE CON CHIAVETTA DI TRASCINAMENTO MILL HOLDERS WITH FEATHER KEY

### FORMA A

### FORMA A

TIPO	Art.	D	H	L	E			
TC 40 - D. 16 CHT	8493	16	45	30	28	0147	4985	4562
TC 40 - D. 22 CHT	8494	22	45	40	36	0148	4986	4563
TC 40 - D. 27 CHT	8495	27	45	60	43	0149	4987	4564
TC 40 - D. 32 CHT	8496	32	45	60	48	0150	4988	4565
TC 40 - D. 40 CHT	8497	40	45	60	56	0151	4989	4566

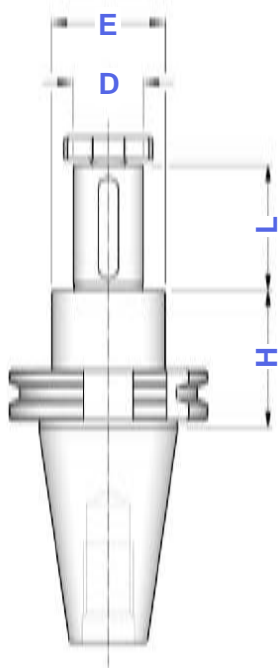





**DIN 69871****PORTAFRESE COMBINATI**  
DIN 6358 SHELL END MILL HOLDERS**FORMA A**

Balanced G 6,3

8.000 rpm

**FORMA  
A**

TIPO	Art.	D	L1	L	E				
TC 30 - D.16 C/H 50	<b>3828</b>	16	27	17	32	4090	0115	4985	4562
TC 30 - D.22 C/H 50	<b>3829</b>	22	31	19	40	4091	0116	4986	4563
TC 30 - D.27 C/H 55	<b>3830</b>	27	33	21	48	4092	0122	4987	4564
TC 40 - D.16 C/H 55 TC 40 - D.16 C/H 100 TC 40 - D.16 C/H 150	<b>3831</b> <b>4100</b> <b>8474</b>	16	27	17	32	4090	0115	4985	4562
TC 40 - D.22 C/H 55 TC 40 - D.22 C/H 100 TC 40 - D.22 C/H 150	<b>3832</b> <b>4101</b> <b>8475</b>	22	31	19	40	4091	0116	4986	4563
TC 40 - D.27 C/H 55 TC 40 - D.27 C/H 100 TC 40 - D.27 C/H 150	<b>3833</b> <b>4102</b> <b>8476</b>	27	33	21	48	4092	0122	4987	4564
TC 40 - D.32 C/H 60 TC 40 - D.32 C/H 100 TC 40 - D.32 C/H 150	<b>3834</b> <b>4103</b> <b>8477</b>	32	38	24	58	4093	0125	4988	4565
TC 40 - D.40 C/H 60 TC 40 - D.40 C/H 100	<b>3835</b> <b>3863</b>	40	41	27	70	4094	0133	4989	4566
TC 45 - D.16 C/H 60	<b>3836</b>	16	27	17	32	4090	0115	4985	4562
TC 45 - D.22 C/H 65 TC 45 - D.22 C/H 100	<b>3837</b> <b>4105</b>	22	31	19	40	4091	0116	4986	4563
TC 45 - D.27 C/H 65 TC 45 - D.27 C/H 100	<b>3838</b> <b>4106</b>	27	33	21	48	4092	0122	4987	4564
TC 45 - D.32 C/H 65	<b>3839</b>	32	38	24	58	4093	0125	4988	4565
TC 45 - D.40 C/H 70	<b>3840</b>	40	41	27	70	4094	0133	4989	4566
TC 50 - D.16 C/H 55 TC 50 - D.16 C/H 100	<b>3841</b> <b>4108</b>	16	27	17	32	4090	0115	4985	4562
TC 50 - D.22 C/H 55 TC 50 - D.22 C/H 100	<b>3842</b> <b>4109</b>	22	31	19	40	4091	0116	4986	4563
TC 50 - D.27 C/H 55 TC 50 - D.27 C/H 100	<b>3843</b> <b>4110</b>	27	33	21	48	4092	0122	4987	4564
TC 50 - D.32 C/H 55 TC 50 - D.32 C/H 100	<b>3844</b> <b>4111</b>	32	38	24	58	4093	0125	4988	4565
TC 50 - D.40 C/H 55 TC 50 - D.40 C/H 100	<b>3845</b> <b>4112</b>	40	41	27	70	4094	0133	4989	4566
TC 50 - D.50 C/H 70	<b>4522</b>	50	46	30	90	4095	0137	4990	4567

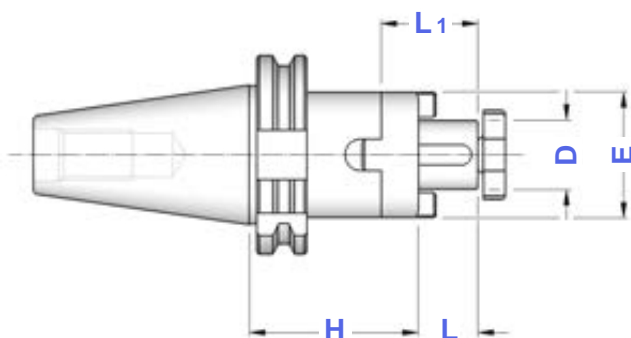



**DIN 69871**

**MASCHIATORI A CAMBIO RAPIDO CON  
DOPPIA COMPENSAZIONE**  
DOUBLE COMPENSATION QUICK CHANGE TAP HOLDERS

**FORMA A****FORMA  
A**

TIPO	Art.	H	E	B	COMPENSAZIONE	
TC 30 - B. 1	<b>2995</b>	74	38	19	- 7,5 + 7,5	M 3 ÷ M 12 (*M16)
TC 30 - B. 2	<b>2996</b>	98	55	31	- 12,5 + 12,5	M 6 ÷ M 20 (*M30)
TC 40 - B. 1	<b>3377</b>	60	38	19	- 7,5 + 7,5	M 3 ÷ M 12 (*M16)
TC 40 - B. 2	<b>3378</b>	98	55	31	- 12,5 + 12,5	M 6 ÷ M 20 (*M30)
TC 40 - B. 3	<b>3379</b>	138	79	48	- 20,0 + 20,0	M14 ÷ M 33 (*M48)
TC 45 - B. 1	<b>3380</b>	60	38	19	- 7,5 + 7,5	M 3 ÷ M 12 (*M16)
TC 45 - B. 2	<b>3381</b>	84	55	31	- 12,5 + 12,5	M 6 ÷ M 20 (*M30)
TC 50 - B. 1	<b>4151</b>	60	38	19	- 7,5 + 7,5	M 3 ÷ M 12 (*M16)
TC 50 - B. 2	<b>3383</b>	83	55	31	- 12,5 + 12,5	M 6 ÷ M 20 (*M30)
TC 50 - B. 3	<b>3384</b>	133	79	48	- 20,0 + 20,0	M14 ÷ M 33 (*M48)

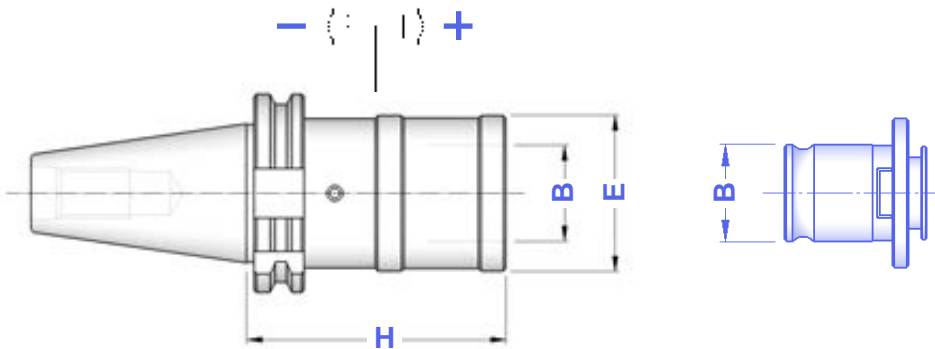

\* Bussole con grani  
Adapters with screws

**DIN 69871**

**MASCHIATORI A CAMBIO RAPIDO  
SENZA COMPENSAZIONE**  
QUICK CHANGE TAP HOLDERS WITHOUT COMPENSATION

**FORMA A (AD)****FORMA  
A**

TIPO	Art.	H	E	B	
TC 30 - B. 1 FISSO	<b>4946</b>	72	33	19	M 3 ÷ M 12 (*M16)
TC 30 - B. 2 FISSO	<b>4947</b>	91	50	31	M 6 ÷ M 20 (*M30)
TC 40 - B. 1 FISSO	<b>4948</b>	59	33	19	M 3 ÷ M 12 (*M16)
TC 40 - B. 2 FISSO	<b>4949</b>	86	50	31	M 6 ÷ M 20 (*M30)
TC 40 - B. 3 FISSO	<b>4991</b>	122	72	48	M14 ÷ M 33 (*M48)
TC 50 - B. 1 FISSO	<b>3062</b>	75	33	19	M 3 ÷ M 12 (*M16)
TC 50 - B. 2 FISSO	<b>4950</b>	98	50	31	M 6 ÷ M 20 (*M30)
TC 50 - B. 3 FISSO	<b>4992</b>	122	72	48	M14 ÷ M 33 (*M48)

\* Bussole con grani  
Adapters with screws

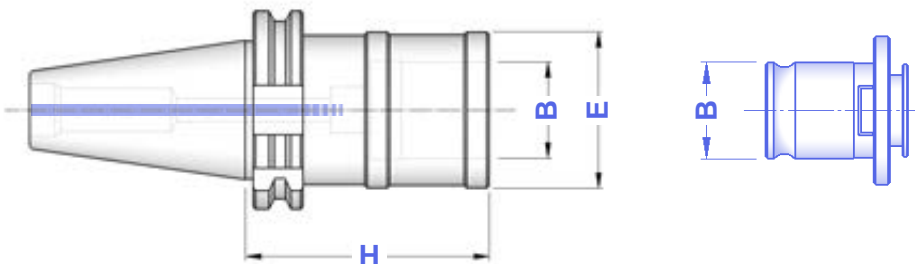

I maschiatori sono fornibili anche con la sola compensazione a trazione (SFILAMENTO)  
Tap holders are also available with traction compensation only (TENSION ONLY)

**SUPPORTI DI MONTAGGIO CONI DIN 69871**  
TIGHTENING FIXTURES for DIN 69871 SHANKS

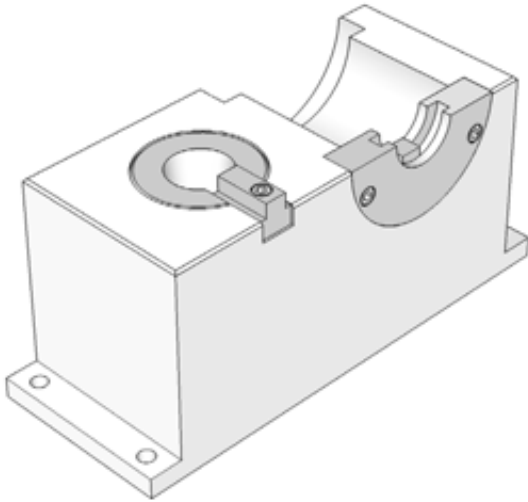

TIPO	Art.	L x P x H
SMD - TC 30/DIN 69871	4608	350 x 135 x 155
SMD - TC 40/DIN 69871	4609	
SMD - TC 50/DIN 69871	4610	



**BOCCOLE**  
PLASTIC BUSHES

TIPO	Art.	
BOCCOLA ISO 30	4416	0033
BOCCOLA ISO 40	4417	0033
BOCCOLA ISO 45	4418	0033
BOCCOLA ISO 50	4419	0033

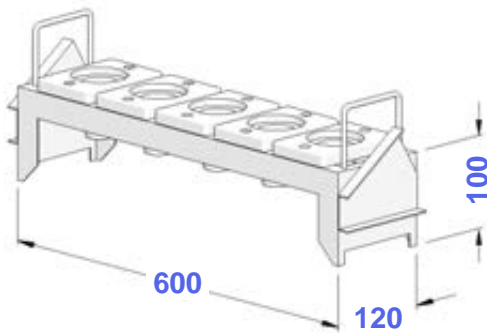

**UNITA' DA BANCO**  
BENCH UNITIES

TIPO	Art.	N° SEDI	
UNITÀ ISO 30	4404	6	4416
UNITÀ ISO 40	4405	6	4417
UNITÀ ISO 45	4330	6	4418
UNITÀ ISO 50	4406	5	4419

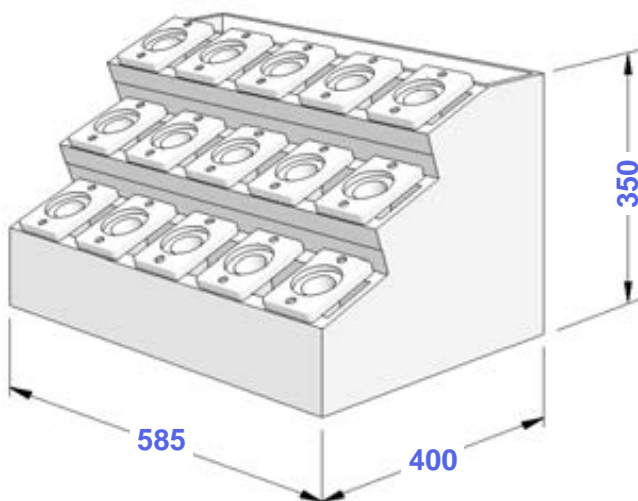

**MAGAZZINI PORTAUTENSILI**  
TOOLHOLDERS STORES

TIPO	Art.	N° SEDI	
MAG. ISO 30	3700	15	4416
MAG. ISO 40	3701	15	4417
MAG. ISO 45	3702	15	4418
MAG. ISO 50	3703	12	4419